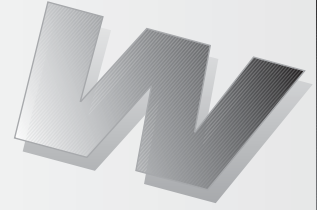

**QUALITY****ATV  
WARRANTY  
Bulletin**

► **NOTE: Repair only if described symptoms exist or are noticed.**

December 22<sup>nd</sup>, 2011 Subject: **Alpine Flex Push Frame Quick Attach Update**

No. **2012-4**

YEAR	MODEL	MODEL NUMBER	SERIAL NUMBER
2012	Alpine Flex Push Frame Quick Attach for Outlander and Renegade	715 001 467	All
		715 001 472	
		705 005 234	

## PROBLEM

A limited quantity of alpine flex push frame may not hold properly to the vehicle.

## SOLUTION

Replace the hook assembly and update the quick attach system.

**NOTE:** Quick attach system kits in stock at BRP have been updated.

OLD P/N	NEW P/N (UPDATED KIT)
715 001 467	715 001 708
715 001 472	715 001 709

## REQUIRED PARTS

Order kit as per normal channel

DESCRIPTION	P/N	QTY
Hook assembly Kit	715 001 714	1

### HOOK ASSEMBLY KIT 715 001 714 (INCLUDES THE FOLLOWING)

PART	QTY
Hook assembly	1
M10 X 1.5 elastic stop nut	6
M6 X 1.0 elastic stop nut	3
M6 X 1.0 X 25mm screw	1
Tension spring	2
4 X 20mm spring pin	1

## PUSH FRAME VERIFICATION

1. Before working on a push frame already installed on a vehicle, verify if the quick attach system was already updated:

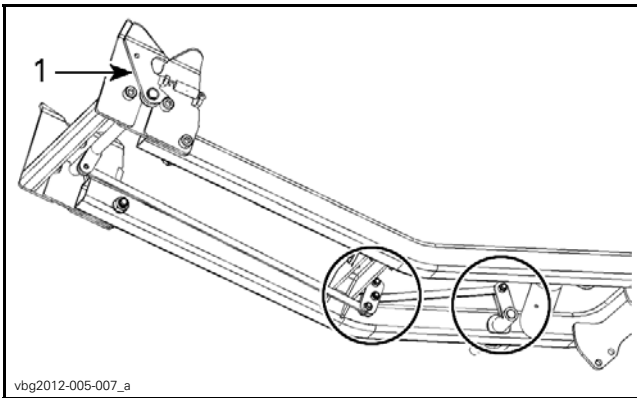

vbg2012-005-007\_a

**QUICK ATTACH SYSTEM THAT NEEDS TO BE UPDATED**  
1. Black painted hooks

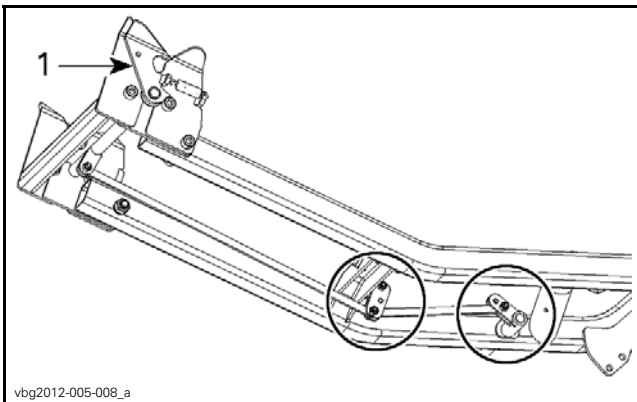

vbg2012-005-008\_a

**UPDATED QUICK ATTACH SYSTEM**  
1. Zinc plated hooks

## PROCEDURE

### Original Hook Assembly Removal

1. On both sides, remove the following:
  - Bolts
  - Springs

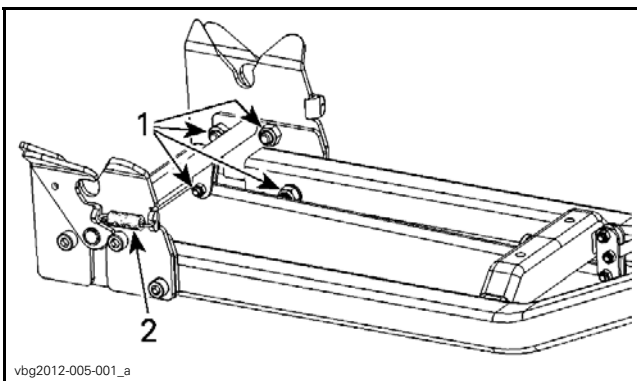

vbg2012-005-001\_a

1. Bolts
2. Spring

2. Remove the rear section of the push frame.
3. Remove the hook assembly.
4. Remove the plastic washers from the hook assembly and keep them.

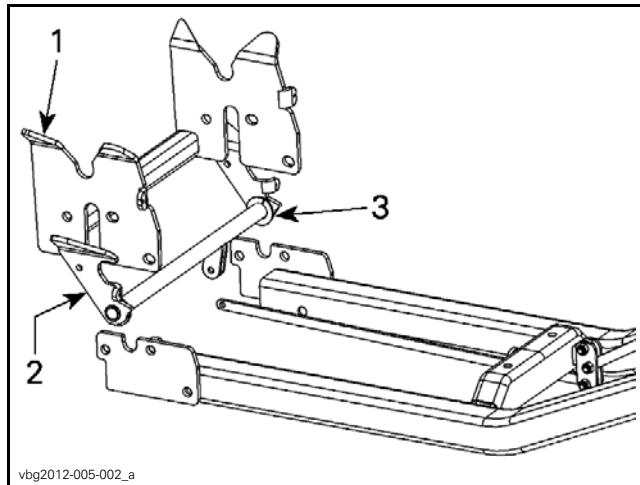

vbg2012-005-002\_a

1. Rear section of the push frame
2. Hook assembly
3. Plastic washer

### New Hook Assembly Installation

1. Install the plastic washers on the new hook assembly.
2. Install the new hook assembly on the push frame.
3. Reinstall the rear section using **NEW** M10 elastic stop nuts.

**NOTE:** On both sides, reinstall the flat washers at the location shown.

4. Install the new tension springs.

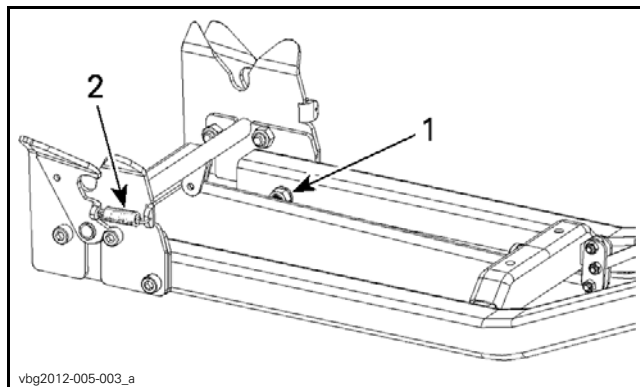

vbg2012-005-003\_a

1. Install washer (on both sides)
2. Spring (install on both sides)

TIGHTENING TORQUE	
M10 bolts	48 N•m (35 lbf•ft)

### Quick Attach System Modification

1. Remove the front link bar.
2. Remove the front bolt of the rear link bar.

- Remove the front lever by removing the spring pin.

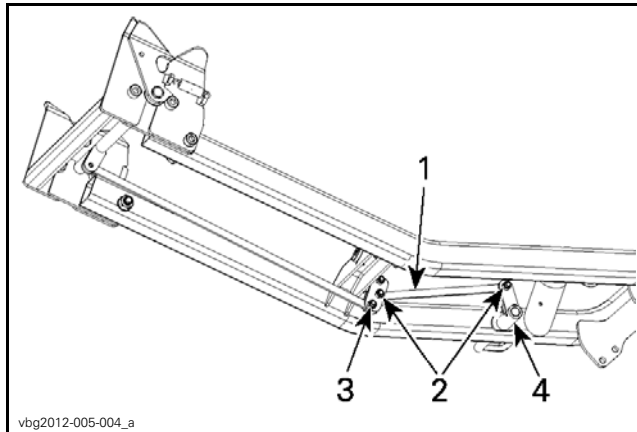

- Front link bar
- Front link bar bolts
- Rear link bar front bolt
- Front lever

- Drill a 6.35 mm (1/4 in) hole through the front lever using the following dimensions or the template attached on the last page of this bulletin.

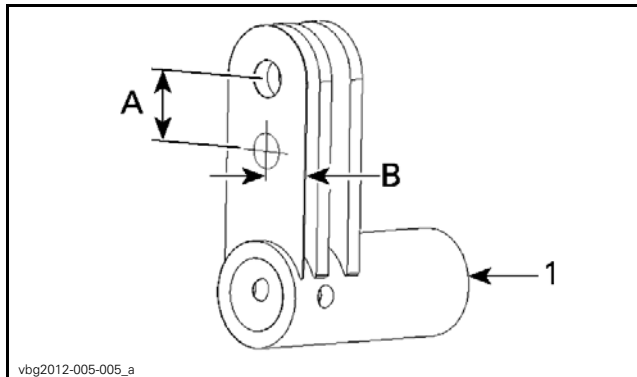

- Front lever
- A. 12.7 mm (1/2 in)
- B. 9.52 mm (3/8 in)

- Reinstall the front lever using a **NEW** spring pin. For the following steps, do not overtighten.
  - Allow link bars and lever to rotate freely
  - Avoid parts deformation.
- Reinstall the front link bar in the hole newly drilled in the front lever. Use a **NEW** elastic stop nut.
- Install both front and rear link bars in the lower pivot hole using:
  - Provided M6 X 2.5mm screw
  - NEW** elastic stop nut.
- Reinstall the rear link bar on the hook assembly using a **NEW** elastic stop nut.

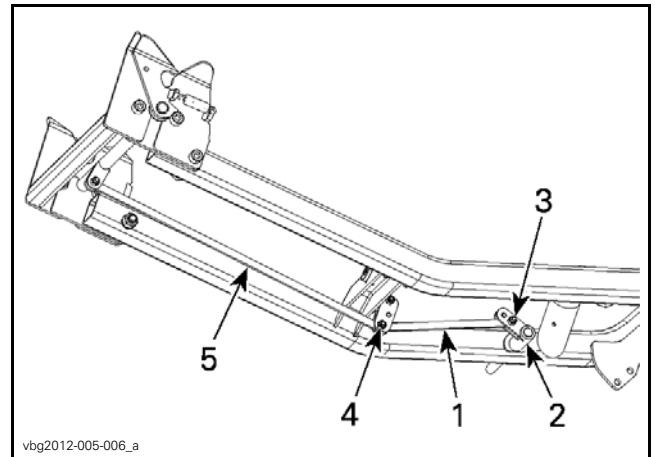

- Front link bar
- Front lever
- Bolt in the newly drilled hole
- Front and rear link bar in the same hole
- Rear link bar

## WARRANTY

Submit a warranty claim using the following information:

In BOSSWeb, under the **Service** tab, select **Parts Claim**.

In **Parts Claim**:

- Fill **Repair Order Number**
- Select the **Product Line**: ATV
- Leave **Authorization Number** empty
- In **Part Type**, select **Over the counter** if kit has already been sold and installed, or select **From Inventory** if kit is in stock (not installed yet)
- Enter the vehicle **Serial Number** (If "Over the Counter" was selected)
- Enter the accessory **Purchase Date** (If "Over the Counter" was selected)
- Enter the accessory **Failure Date**
- Enter the accessory **Repair Completion Date**
- In **Nature of Defect**, enter: "Plow Push Frame Update (Quality Bulletin 2012-4)"
- In **Trouble Part Number**, enter (P/N 715 001 467) or (P/N 715 001 472) accordingly
- In **System Code**, select 11
- In **Trouble Code**, select "W02, (accessories) after installation"
- In **Parts Required for Repair**, enter Qty 1, (P/N 715 001 714)
- If Over the counter was selected, in **Labor Only** use (P/N 715 001 467) or (P/N 715 001 472), with 0.5 hour of labor.

---

***This page is  
intentionally blank***

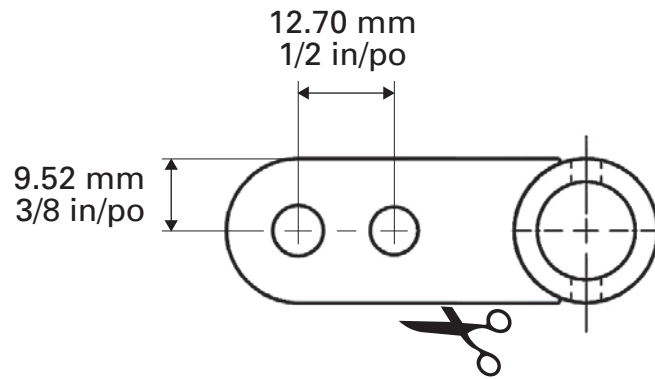

Ensure template is to scale/  
S'assurer que le gabarit est à l'échelle

vbg2012-005-009\_a