

Date : **January 19 2009**

Subject : **Service Tools**

No

2009-15

Year	Model
All	All

BRP is proud to introduce its latest Service Tools Bulletin. These special tools were designed to help you efficiently service BRP vehicles. Please always make sure to use special tools along with the appropriate Shop Manual(s) and respect all safety measures.

Mandatory Tools: These tools are absolutely needed to perform certain service procedures. They will be automatically shipped to dealerships. They do not need to be ordered separately.

Recommended Tools: These tools will facilitate the Technicians work. They will not be automatically shipped to dealerships. They need to be ordered separately.



Table of contents

Tools by System:

Engine	P 2
Fuel	P 16
Cooling	P 18
Electrical	P 19
Lubrication	P 22
Transmission / Propulsion	P 23
Brake	P 31
Steering	P 31
Suspension	P 32
Body	P 35
Various	P 35

Index of tools by Part Number:	P 37
---	------

Engine

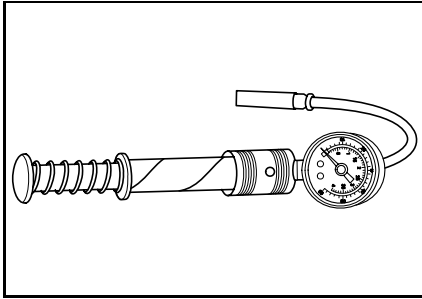

Leakage tool Mikuni BN pump
P/N 295 000 114 Recommended
 All carbureted engines
 To leak test carburetor pop-off pressure.

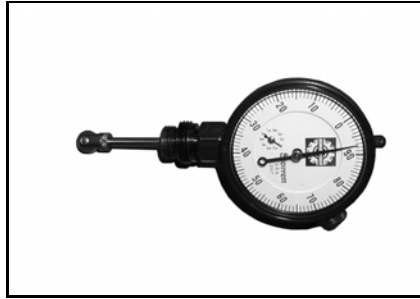

TDC dial indicator
P/N 295 000 143 Recommended
 2-stroke engines except DI, 1203

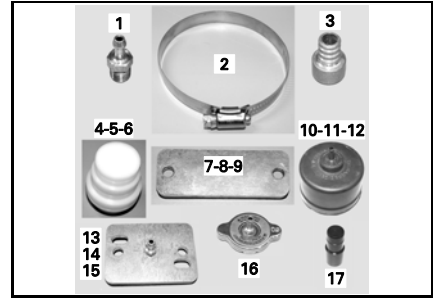

Fitting (item 1)
P/N 408 201 100 Recommended
 All 2-stroke engines
 Replacement part for item included in kit 861749100

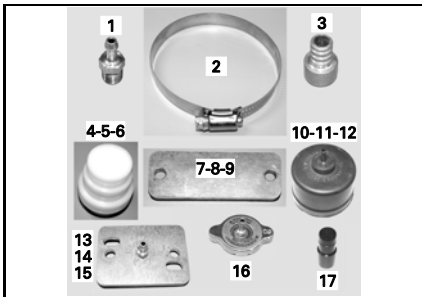

Clamp (item 2)
P/N 408 803 500 Recommended
 All 2-stroke engines
 Replacement part for item included in kit 861749100

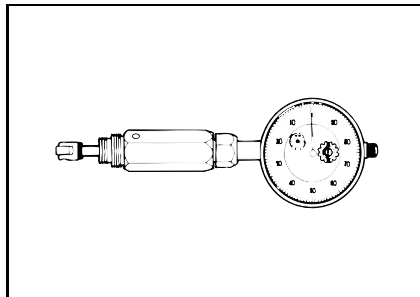

TDC dial indicator
P/N 414 104 700 Recommended
 For ignition timing static measurement

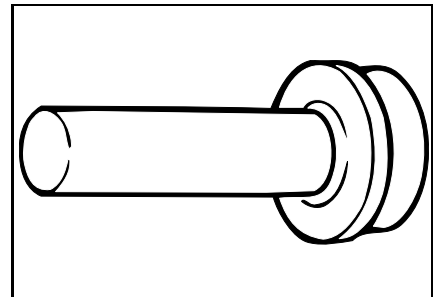

Polyamid ring pusher
P/N 420 267 930 Recommended
 247 engine



Half-ring puller MAG
P/N 420 276 025 Recommended
 717 engine
 To remove crankshaft bearings.

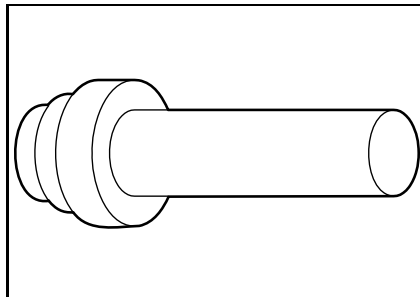

MAG seal pusher
P/N 420 277 875 Recommended
 277f

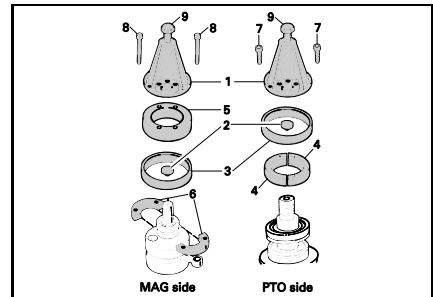

M8 x 40 screw (item 7)
P/N 420 840 681 Recommended
 All 2-stroke engines

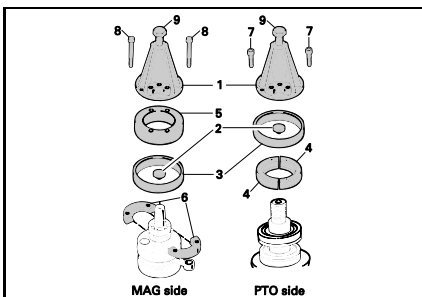

M8 x 70 screw (item 8)
P/N 420 841 201 Recommended
 All 2-stroke engines
 To be used with P/N 420 877 635.



Magneto puller
P/N 420 876 081 **Mandatory**
 All 2-strokes

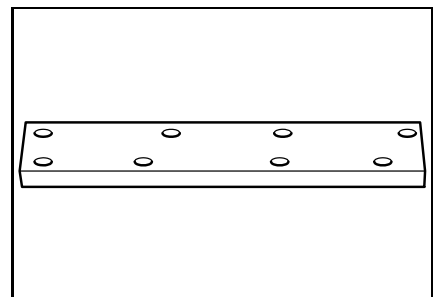

Cylinder alignment tool
P/N 420 876 171 Recommended
 377f, 440f
 To use on exhaust side

Engine

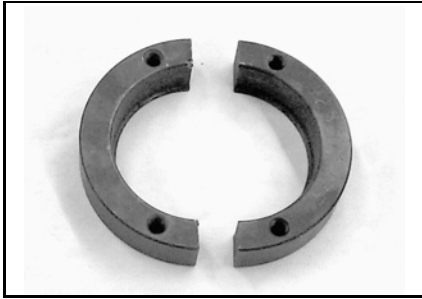

Half-ring puller
P/N 420 876 330 Recommended
 947 and 947 DI engines
 To remove 52 mm O.D. bearings from the crankshaft.

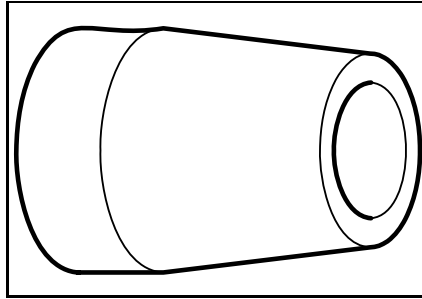

Seal protector sleeve
P/N 420 876 490 Recommended
 Rotary valve engine with 12 mm shaft

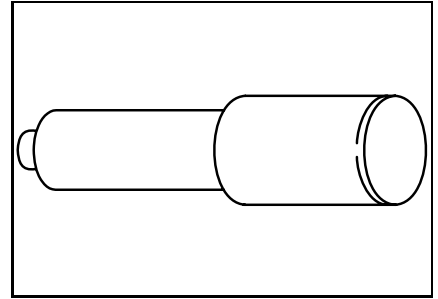

Rotary valve bearing pusher
P/N 420 876 500 Recommended
 Rotary valve engines

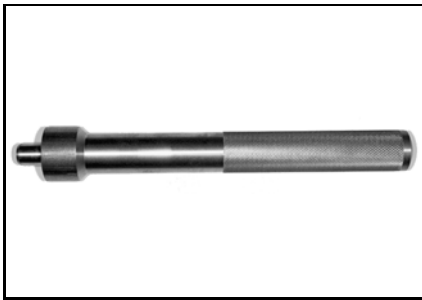

Rotary valve bearing pusher
P/N 420 876 501 Recommended
 717, 787 and 787 RFI engines

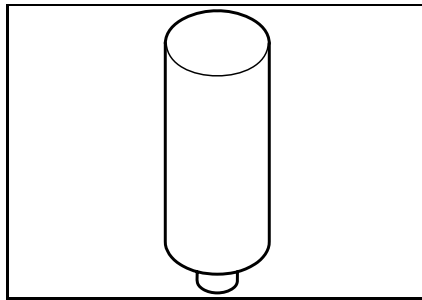

Rotary valve seal pusher
P/N 420 876 510 Recommended
 440F
 All rotary valve shaft seal with 12 mm I. D.

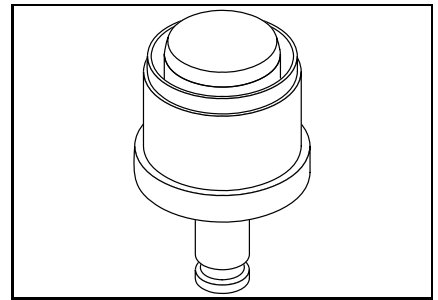

Insertion jig (magneto seal)
P/N 420 876 514 Recommended
 454, 494, 599, 670, 699 and 809

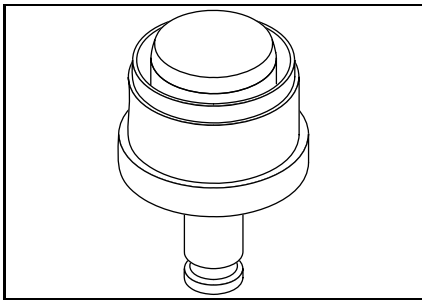

Gasket pusher (magneto side seal)
P/N 420 876 516 Recommended
 599, 699, 779, 809



Crankshaft protector (PTO)
P/N 420 876 552 Recommended
 All 2-stroke, 1203
 Use with 420877635



Crankshaft protector (MAG)
P/N 420 876 557 Recommended
 717 / 787 RFI / 800R / 800 HO



Crankshaft distance ring (MAG)
P/N 420 876 569 Recommended
 All 2-stroke engines

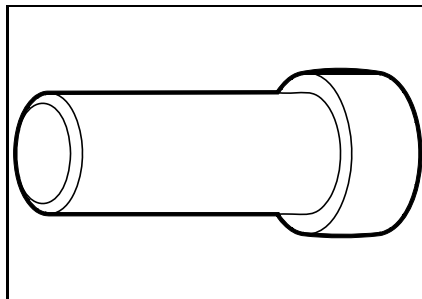

Rotary valve shaft installer
P/N 420 876 605 Recommended
 717 engines and older than 1990

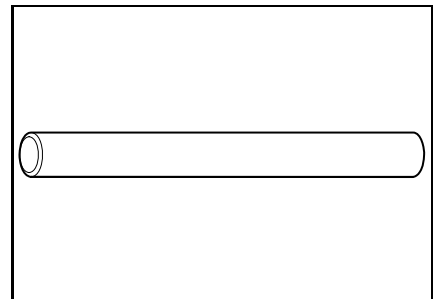

Rotary valve shaft pusher
P/N 420 876 610 Recommended
 500lc
 All rotary valve engine with 12 mm shaft.

Engine

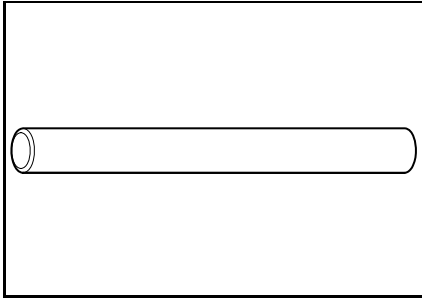

Rotary valve shaft pusher
P/N 420 876 612 Recommended
 Engines with 10 mm rotary shaft

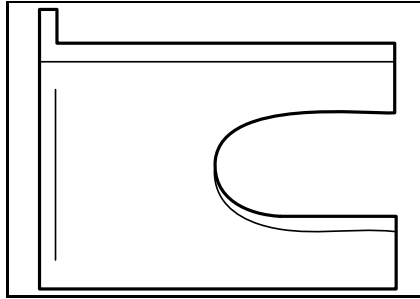

Feeler gauge
P/N 420 876 620 Recommended
 377, 443, 447 and 503

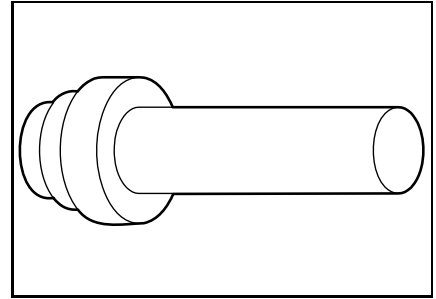

PTO seal pusher
P/N 420 876 660 Recommended
 277

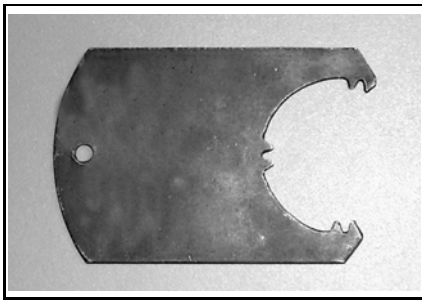

Gear holder
P/N 420 876 695 Recommended
 277F, 377F, 447 and 503
 To hold the oil pump gear

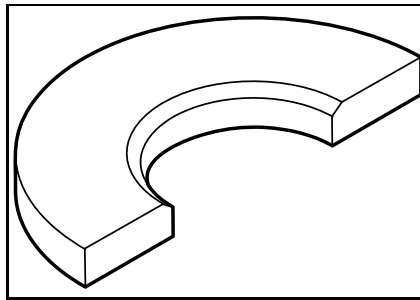

Distance gauge 5.7 mm
P/N 420 876 822 Recommended
 377, 443 and 447

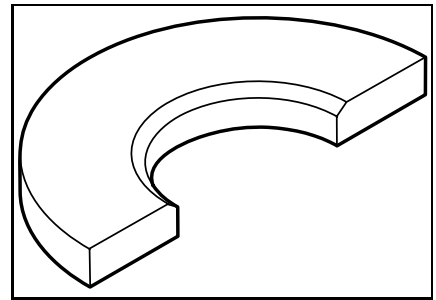

Crankshaft distance gauge 12.7 mm
P/N 420 876 824 Recommended
 503F

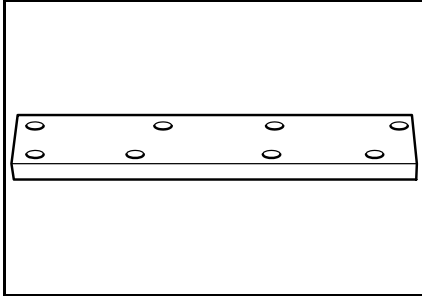

Cylinder alignment tool
P/N 420 876 904 Recommended
 717 engines

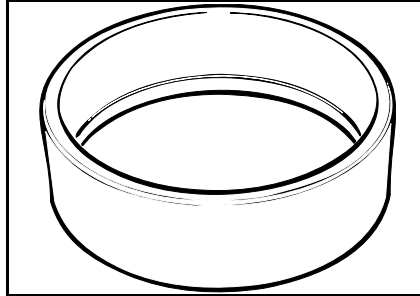

Magneto centering tool
P/N 420 876 922 Recommended
 717 engines
 All engines with Nippondenso 160 W CDI.

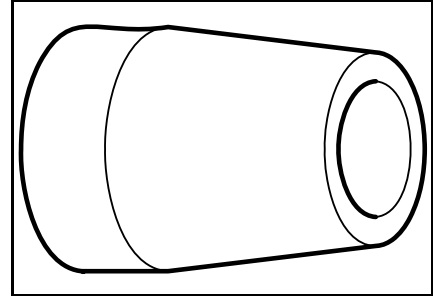

Seal protector sleeve
P/N 420 876 980 Recommended
 Rotary valve engines with 10 mm shaft

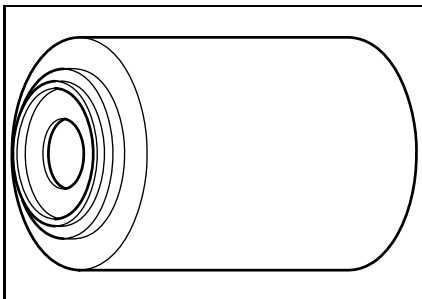

Rotary valve seal pusher
P/N 420 877 050 Recommended
 500, 583, 670

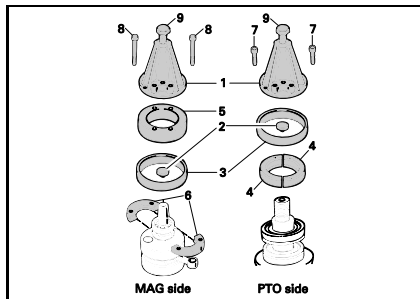

Crankshaft bearing puller
P/N 420 877 635 Recommended
 All 2-stroke engines

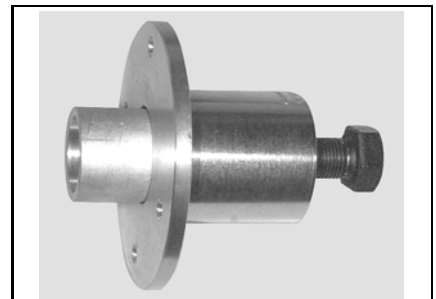

Ceramic seal pusher
P/N 420 877 820 Recommended
 494 and 670

Engine

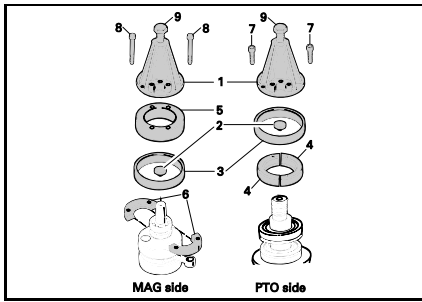

Replacement puller bolt (item #9)
P/N 420 940 755 Recommended
 All 2-stroke engines
 To use with puller P/N 420 877 635.

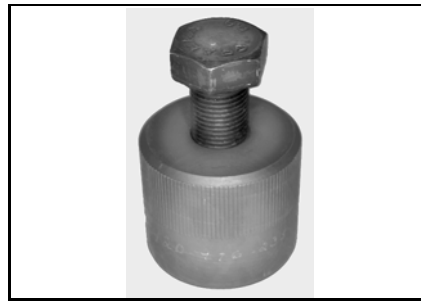

Flywheel puller
P/N 420 976 235 Recommended
 247, 787, 787 RFI, 947 and 947 DI eng.
 Replacement bolt P/N 529 035 549.

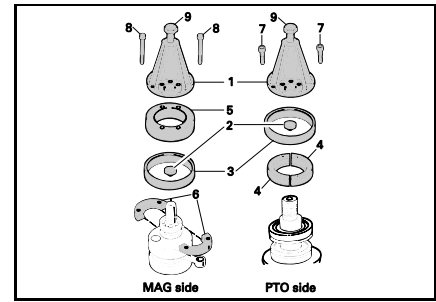

Crankshaft protector (item 2)
P/N 420 976 890 Recommended
 247 engine



Half-rings
P/N 420 977 475 Recommended
 717 / 787 RFI engines

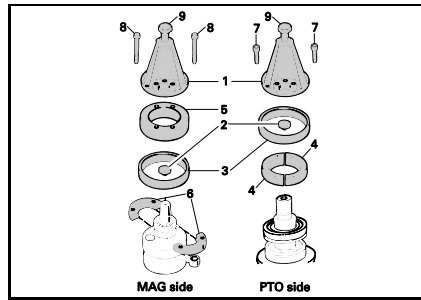

Half-rings
P/N 420 977 479 Recommended
 599, 699, 779, 809
 3 cylinders crankshaft bearing remover; to use with 420877635

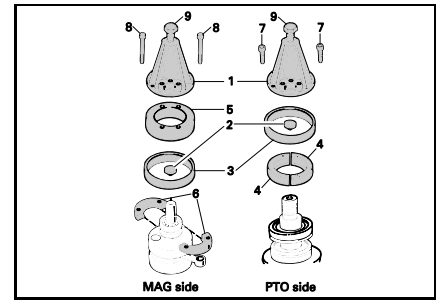

Holder ring (item 3)
P/N 420 977 480 Recommended
 947DI engines

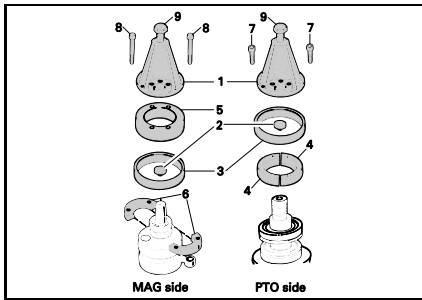

Puller ring
P/N 420 977 490 Recommended
 717/787 RFI engines

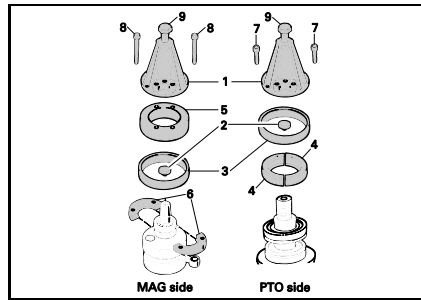

Puller ring
P/N 420 977 494 Recommended
 599, 699, 779, 809
 Crankshaft bearing installer

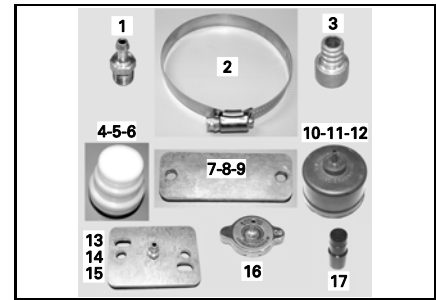

Adapter (item 3)
P/N 517 234 900 Recommended
 All 2-stroke engines
 Replacement part for item included in kit 861749100

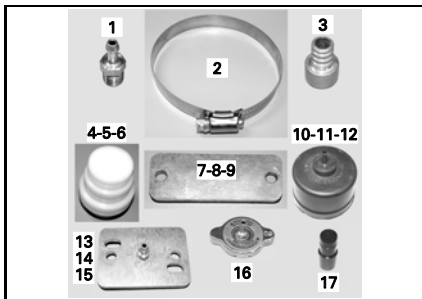

Replacement rubber seal (item 13)
P/N 529 010 902 Recommended
 For kit 529010900

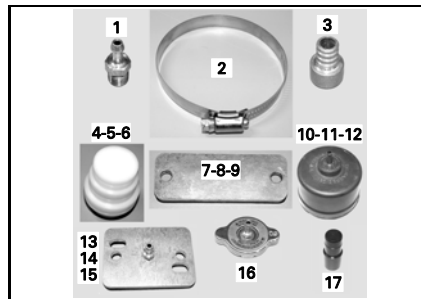

Intake plug (item 4)
P/N 529 011 000 Recommended
 All 2-stroke engines
 Replacement part for item included in kit 861749100

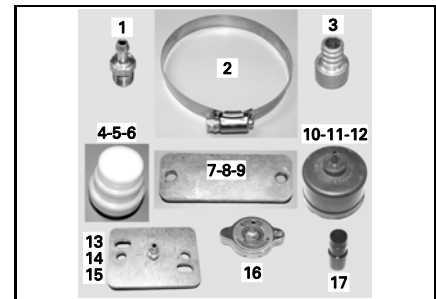

RAVE plate (item 7)
P/N 529 011 200 Recommended
 All 2-stroke engines
 Replacement part for item included in kit 861749100

Engine

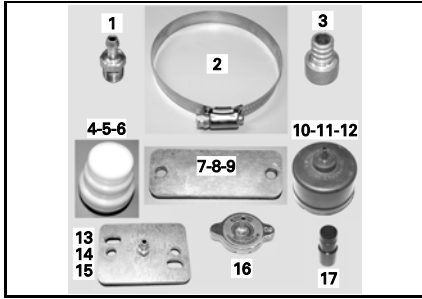

Replacement rubber seal (item 8)
P/N 529 011 203 Recommended
 All 2-stroke engines
 Replacement part for item included in kit 861749100



Circlip installer
P/N 529 016 900 Recommended
 Replaced by 529035562

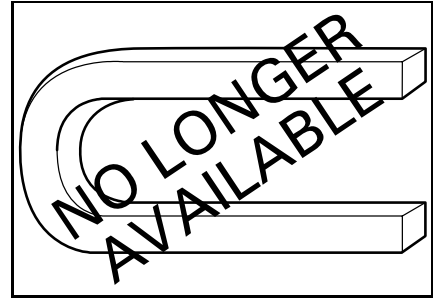

Rotary valve circlip tool
P/N 529 020 800 Recommended
 1993 and earlier rotary valve engines

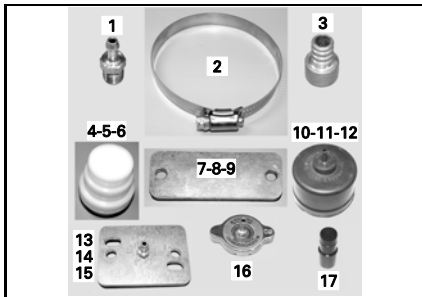

Manifold plug 57 mm (2-1/4") (item 10)
P/N 529 021 100 Recommended
 All 2-stroke engines
 Replacement part for item included in kit 861749100

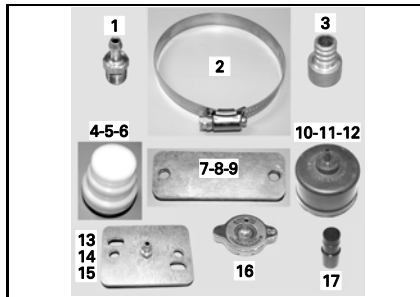

Manifold plug 70 mm (2-1/4) (item 12)
P/N 529 021 200 Recommended
 All 2-stroke engines
 Replacement part for item included in kit 861749100

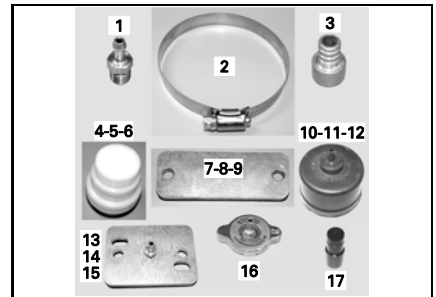

Exhaust plate (item 13)
P/N 529 021 300 Recommended
 All 2-stroke engines
 Replacement part for item included in kit 861749100

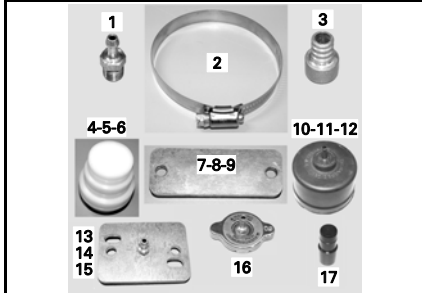

Replacement rubber seal (item 13)
P/N 529 021 302 Recommended
 Replacement part for kit 861749100



Vacuum/pressure pump
P/N 529 021 800 Recommended
 All models



Magneto puller
P/N 529 022 500 Recommended
 Replaced by 529035547

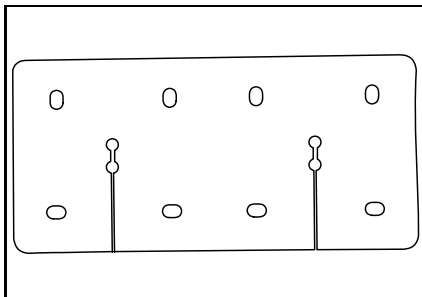

Rubber pad protector
P/N 529 023 400 Recommended
 1999 CK3 & S200 cageless bearing engines

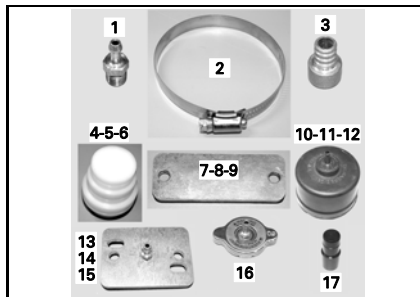

Exhaust plate (item 14)
P/N 529 024 600 Recommended
 All 2-stroke engines
 Replacement part for item included in kit 861749100

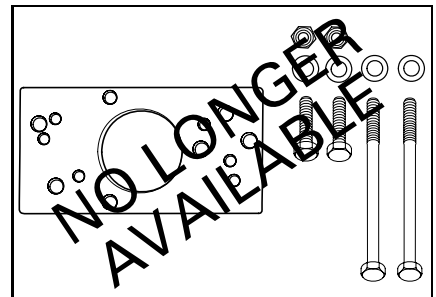

Base puller plate kit
P/N 529 024 900 Recommended
 277

Engine

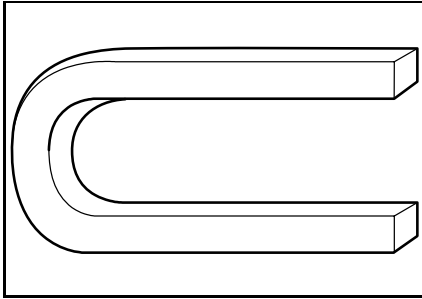

Rotary valve circlip tool
P/N 529 029 100 Recommended
 1994 and more recent rotary valve engine

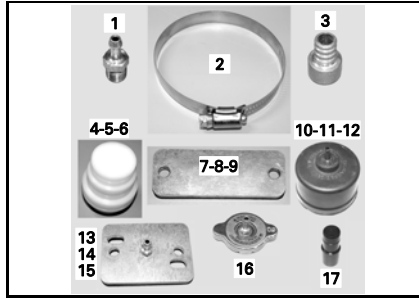

Intake plug (item 5)
P/N 529 030 500 Recommended
 All 2-stroke engines
 Replacement part for item included in kit 861749100



Piston ring compressor 78 mm
P/N 529 030 800 Recommended
 670 engine



Leak test kit
P/N 529 033 100 **Mandatory**
 All models



Exhaust spring installer/remover
P/N 529 035 400 Recommended
 Replaced by 529035983

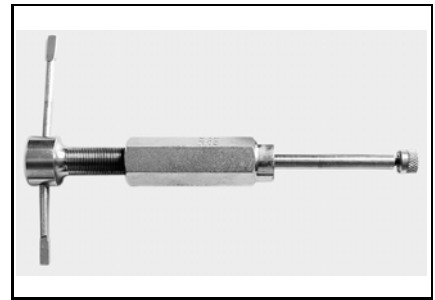

Piston pin puller
P/N 529 035 503 Recommended
 All 2-stroke engines

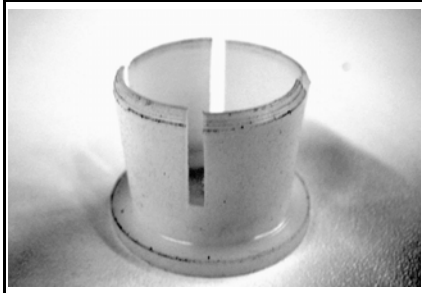

Replacement protector sleeve
P/N 529 035 513 Recommended
 To be used with P/N 529 035 503.

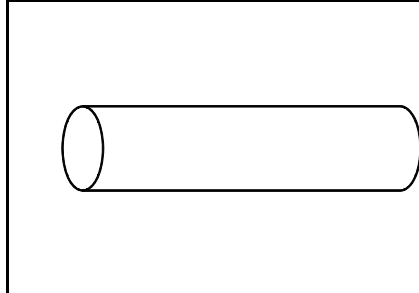

Driver tool
P/N 529 035 521 Recommended
 Mini Z

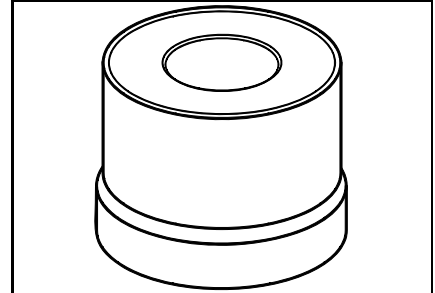

Attachment
P/N 529 035 522 Recommended
 Mini Z

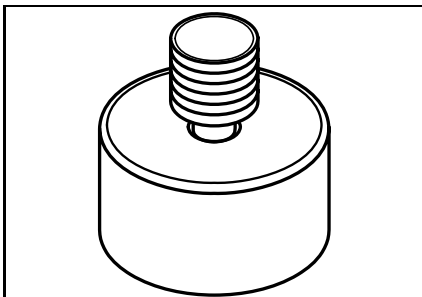

Bearing pusher 2 2mm
P/N 529 035 523 Recommended
 Mini Z



Sleeve kit 18 mm
P/N 529 035 541 **Mandatory**
 Ski-Doo 277, Sea-Doo 587
 To install cageless bearings. Used with 529035503

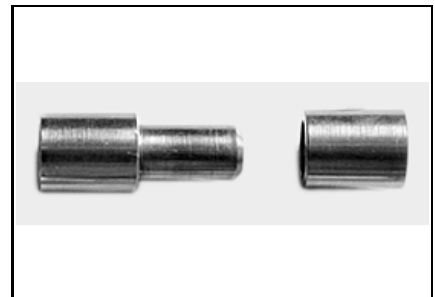

Sleeve kit 20 mm
P/N 529 035 542 **Mandatory**
 717, 787 RFI, 600, 800 HO
 Used with 529035503

Engine

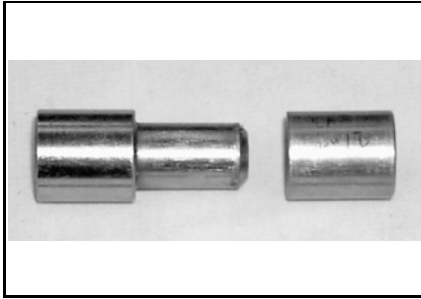

Sleeve kit 21 mm

P/N 529 035 543

Mandatory

947, 947 DI, 800 R engines

To install cageless bearings. Used with 529035503

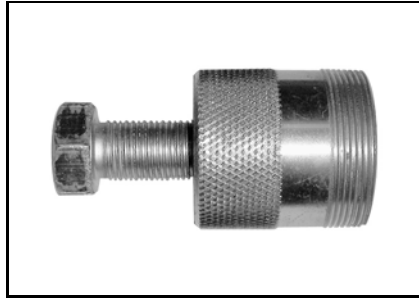

Magneto puller

P/N 529 035 547

Mandatory

Replacement bolt 529035549. Use

20876081/295000125/420841591/29084722
0

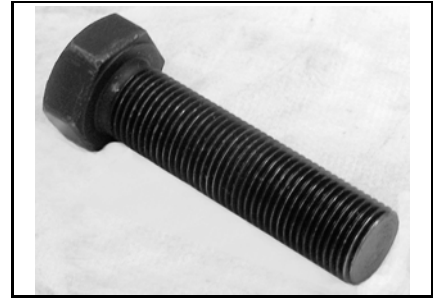

Bolt M16 x 1.5 x 65 mm

P/N 529 035 549

Recommended

DS 450

Goes with 529 035 547 & 420 976 235.

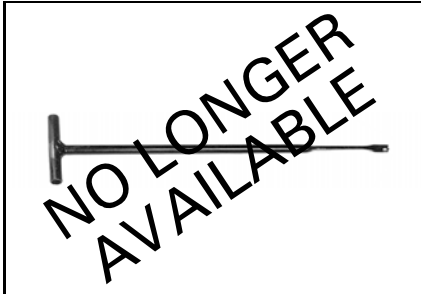

Spring installer remover

P/N 529 035 559

Recommended

Replaced by 529035983 or 529035989



Piston circlip installer 18 mm

P/N 529 035 561

Recommended

Sea-Doo 587, Ski-Doo 277 engines

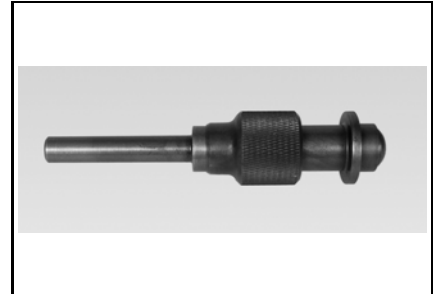

Circlip insertion tool 20 mm

P/N 529 035 562

Recommended

593, 670, 693, 717, 787 & 787 RFI engine
Sleeve without groove P/N 529 035 567 also
available.



Circlip insertion tool 21 mm

P/N 529 035 563

Recommended

947 and 947 DI engines

Sleeve without groove, P/N 529 035 569 also
available.



18 mm sleeve

P/N 529 035 565

Recommended

Replacement part for 529035561



20 mm sleeve

P/N 529 035 567

Recommended

Use with 529 035 562.



21 mm sleeve

P/N 529 035 569

Recommended

Use with P/N 529 035 563.

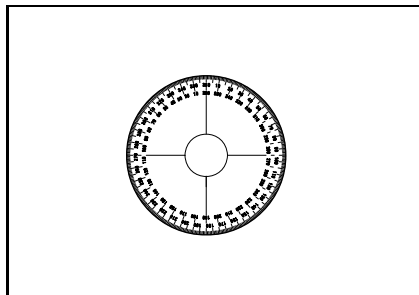

Degree wheel

P/N 529 035 607

Mandatory

All rotary valve engines



Engine leak down test kit

P/N 529 035 661

Recommended

All 4-stroke engines

To perform a leak down test on engine.

Engine

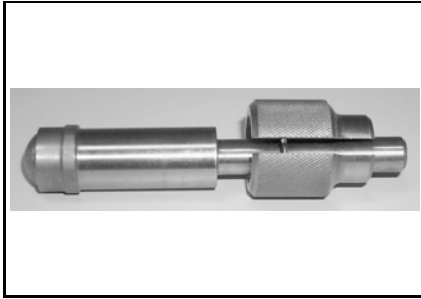

Piston circlip installer
P/N 529 035 686 **Mandatory**
 All engines with tab type circlip

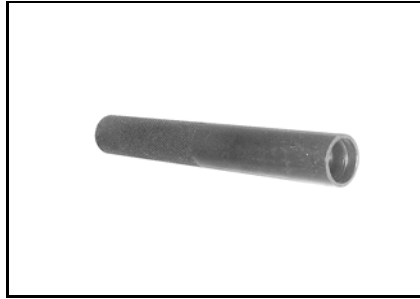

Valve stem seal installer
P/N 529 035 687 Recommended
 1503 engine



Valve spring compressor
P/N 529 035 724 Recommended
 4-TEC engines
 To be used with valve spring compressor cup 529 035 764 and 529 036 073



Valve spring compressor cup
P/N 529 035 764 Recommended
 V-1000/ V-1300/330/400/490/660/810
 To be used with valve spring compressor 519 035 724.

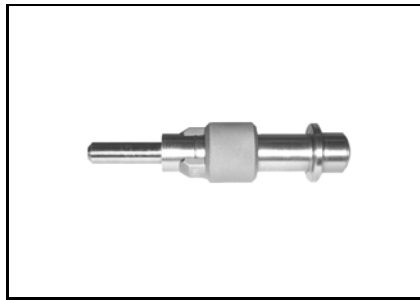

Piston circlip installer
P/N 529 035 765 Recommended
 610/500/1503/V-1000 engines

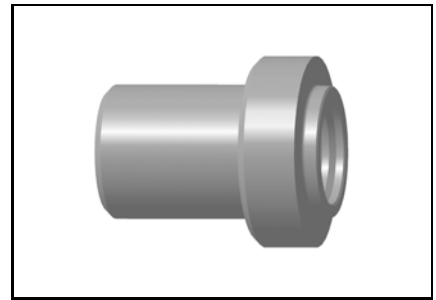

Water pump ceramic seal installer
P/N 529 035 766 Recommended
 All V-twin, 330/400, 610/500, 500 eng.
 Use with 529 036 130

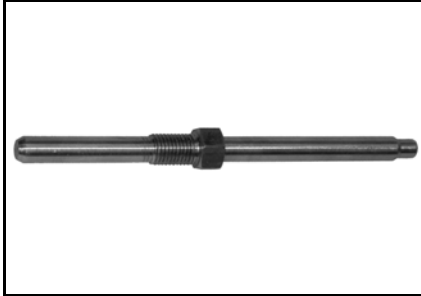

Crankshaft locking tool
P/N 529 035 821 Recommended
 4-TEC 1503 engines

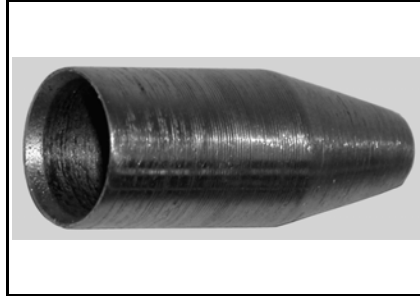

Oil seal guide
P/N 529 035 822 Recommended
 4-TEC 1503 engines



Engine lifting hook
P/N 529 035 829 **Mandatory**
 REV, RT

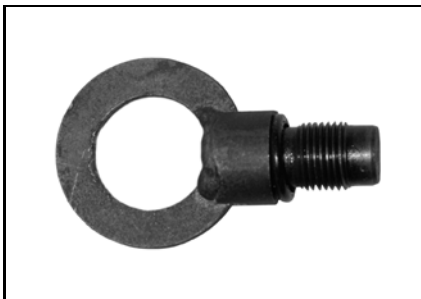

Engine lifting ring
P/N 529 035 830 **Mandatory**
 2-stroke engines with 14 mm spark plugs



Camshaft locking tool
P/N 529 035 839 Recommended
 V1000, V1300 and 1503 engines



Suction pump
P/N 529 035 880 Recommended

Engine

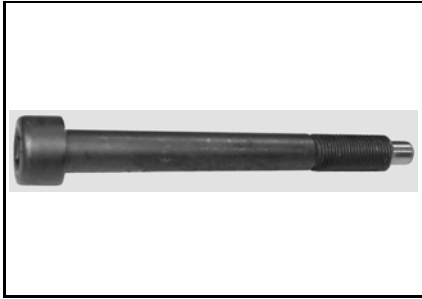

Crankshaft locking tool
P/N 529 035 900 Recommended
 V-1000, V-1300

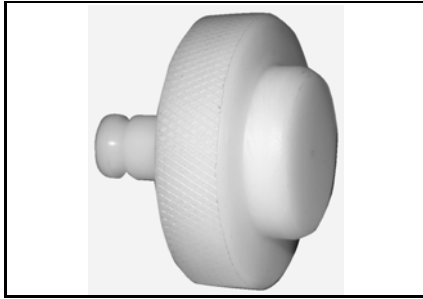

PTO cover oil seal installer
P/N 529 035 910 Recommended
 V1000, V-1300

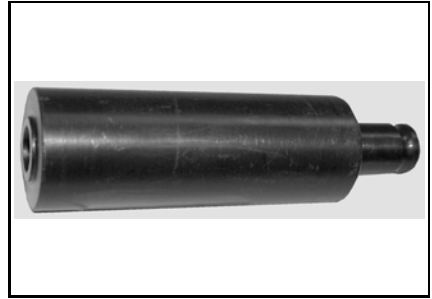

Oil pump seal installer
P/N 529 035 911 Recommended
 4-TEC V1000



Pusher 55/59 mm
P/N 529 035 913 Recommended
 V1000, V1300



Pusher 32/42 mm
P/N 529 035 914 Recommended
 V1000, V1300



Piston ring compressor
P/N 529 035 919 Recommended
 V-800 engine

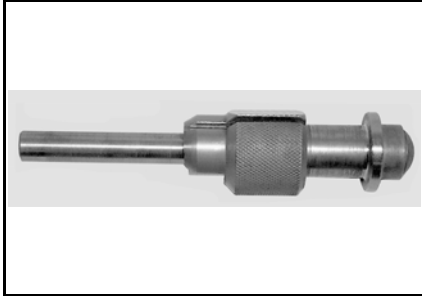

Piston circlip installer
P/N 529 035 921 **Mandatory**
 330, 400, 500, 650, 800 engines



Camshaft locking tool
P/N 529 035 926 **Mandatory**
 400, 500, 650, 800 engines

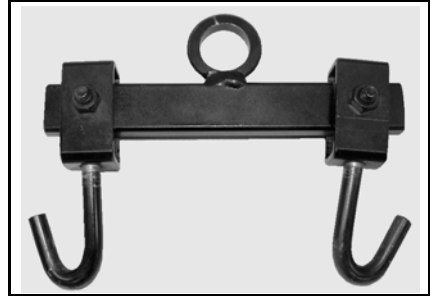

2-stroke engine lifting hook
P/N 529 035 940 Recommended
 All 2-stroke engines

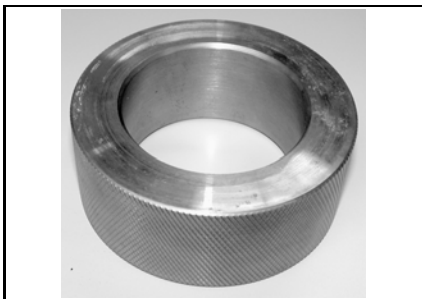

Support sleeve
P/N 529 035 944 Recommended
 V1000, V1300

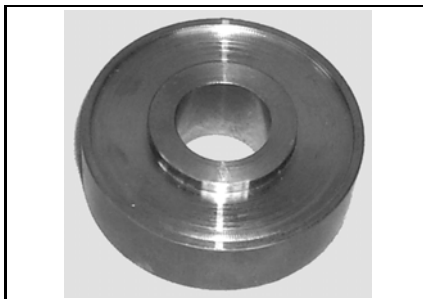

Engine support bearing installer
P/N 529 035 952 Recommended
 Elite



Engine support bearing
P/N 529 035 953 Recommended
 Elite

Engine



Torque flange remover
P/N 529 035 958 Recommended
 Elite

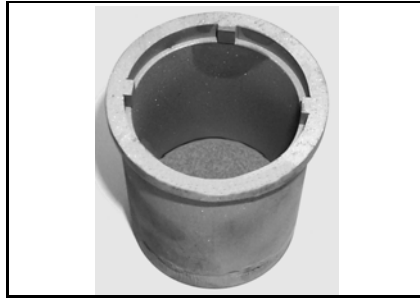

4-tooth socket
P/N 529 035 960 Recommended
 Elite

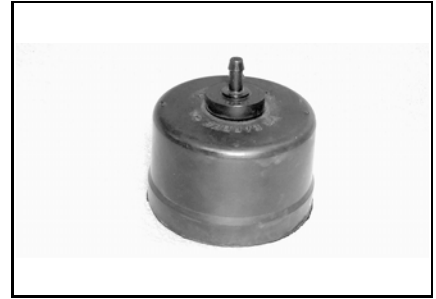

Manifold plug 63 mm (2-1/2")
P/N 529 035 961 Recommended
 All 2-stroke engines
 Replacement part for item included in kit
 861749100

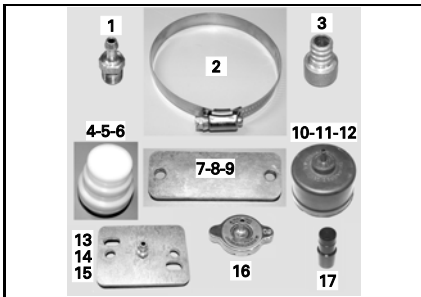

Exhaust plate (item 15)
P/N 529 035 962 Recommended
 All 2-stroke engines
 Replacement part for item included in kit
 861749100

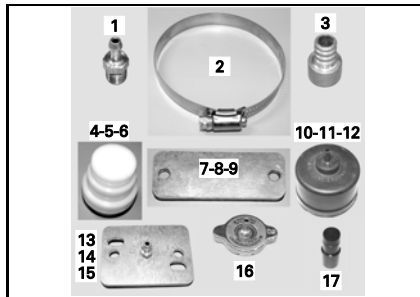

Intake plug (item 6)
P/N 529 035 963 Recommended
 All 2-stroke engines
 Replacement part for item included in kit
 861749100

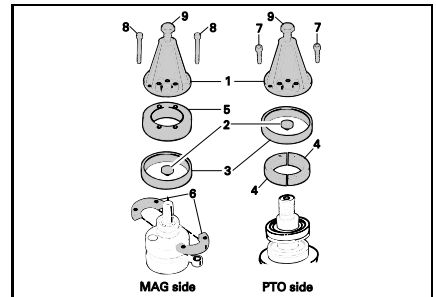

Distance ring (item 14)
P/N 529 035 964 Recommended
 693, 793
 To be used with 420877635, for MAG side
 bearing



Crankshaft distance gauge
P/N 529 035 965 Recommended
 552
 To be used with 529035876



Crankshaft distance gauge
P/N 529 035 966 Recommended
 493 and 593
 To be used with item 529035976



Crankshaft distance gauge
P/N 529 035 967 Recommended
 593HO, 593 SDI, 693 and 793
 To be used with 529035976



Crankshaft distance gauge
P/N 529 035 968 Recommended
 793 HO and 793 HO SDI
 To be used with 529035976



Bearing heater
P/N 529 035 969 **Mandatory**
 All



Temperature indicator stick
P/N 529 035 970 **Mandatory**
 All

Engine

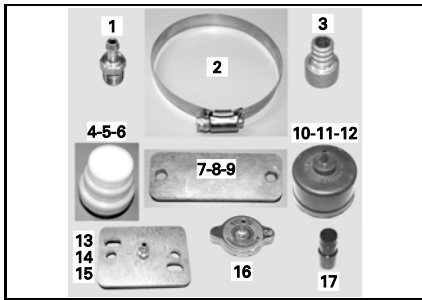

RAVE plate (item 8)
P/N 529 035 971 Recommended
 All 2-stroke engines
 Replacement part for item included in kit
 861749100

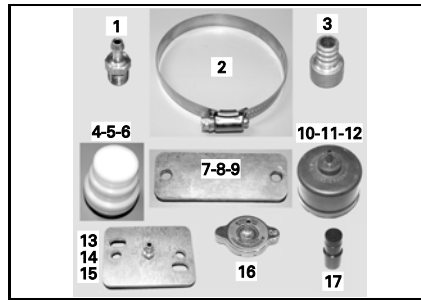

RAVE plate (item 9)
P/N 529 035 972 Recommended
 All 2-stroke engines
 Replacement part for item included in kit
 861749100

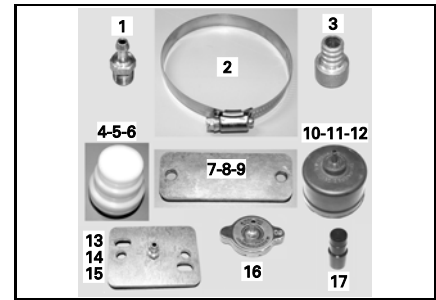

Resonator plug (item 17)
P/N 529 035 973 Recommended
 All 2-stroke engines
 Replacement part for item included in kit
 861749100



Support plate
P/N 529 035 976 Recommended
 3 series and 552 engines
 Used with 529035964, 965, 966, 967 and 96



Crankshaft MAG bearing installer
P/N 529 035 979 Recommended
 493, 593 engines

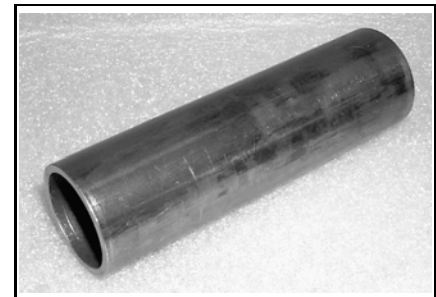

Crankshaft bearing installer (MAG)
P/N 529 035 980 Recommended
 552, 593HO, 693, 793 engines



Bearing installer (PTO)
P/N 529 035 990 Recommended
 552, 593 HO, 693, 793 engines

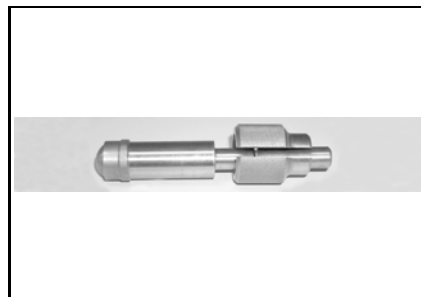

Piston circlip installer
P/N 529 035 998 **Mandatory**
 995 SDI



Exhaust plate
P/N 529 035 999 Recommended
 995 SDI
 For leak test.



Intake plug
P/N 529 036 000 Recommended
 995 SDI
 For leak test.



Magneto puller ring
P/N 529 036 001 **Mandatory**
 995 SDI

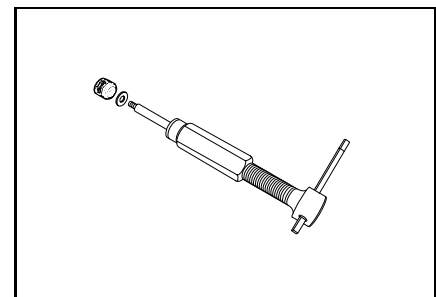

Piston pin puller
P/N 529 036 002 **Mandatory**
 995 SDI

Engine

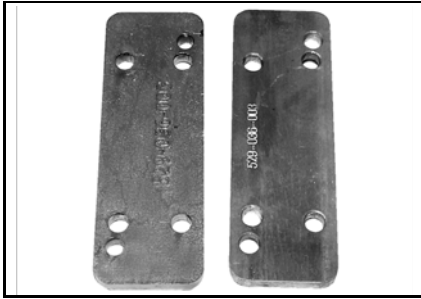

RAVE Plate
P/N 529 036 003 Recommended
 995 SDI
 For leak test.

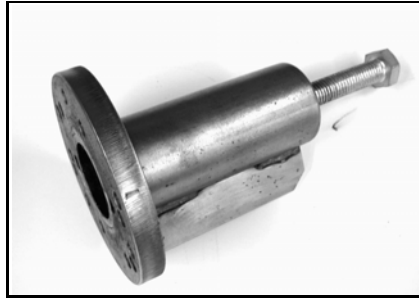

Crankshaft bearing puller
P/N 529 036 004 Recommended
 2-stroke engines

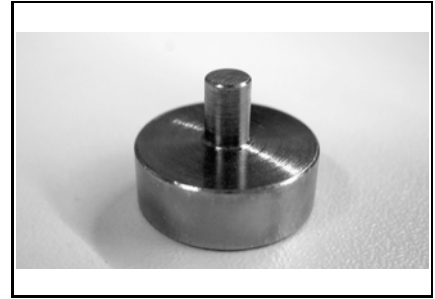

Crank protector
P/N 529 036 011 **Mandatory**
 995 SDI



Ceramic seal installer
P/N 529 036 014 Recommended
 All LC's engines without rotary valve



Engine lifting tool
P/N 529 036 022 Recommended
 V-490, V-660 and V-810 engines

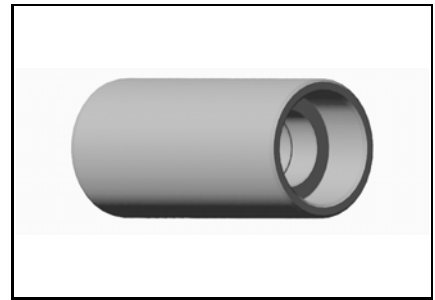

Drive shaft oil seal installer
P/N 529 036 028 Recommended
 V-490, V-660 and V-810 engines

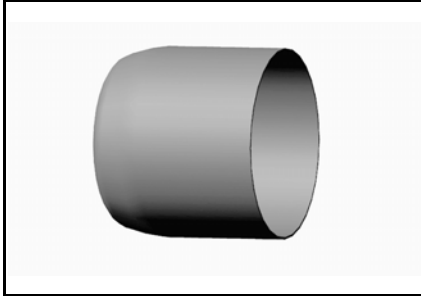

Drive shaft oil seal protector
P/N 529 036 029 Recommended
 V-490, V-660 and V-810 engines



Crankcase support MAG/PTO
P/N 529 036 031 Recommended
 V-490, V-660 and V-810 engines



PTO cover plain bearing remover/install.
P/N 529 036 032 Recommended
 V-490, V-660 and V-810 engines



PTO cover oil seal installer
P/N 529 036 033 Recommended
 V-490, V-660 and V-810 engines



Crankshaft protector
P/N 529 036 034 Recommended
 V-490, V-660 and V-810 engines



Distance gauge
P/N 529 036 060 Recommended
 797

Engine

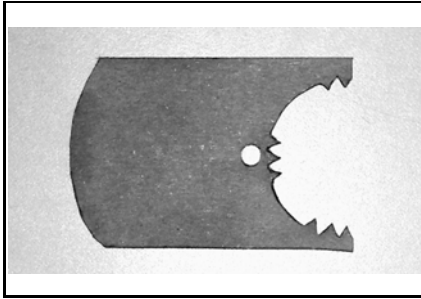

Gear holder
P/N 529 036 061 Recommended
 552 Fan
 To hold oil pump gear.

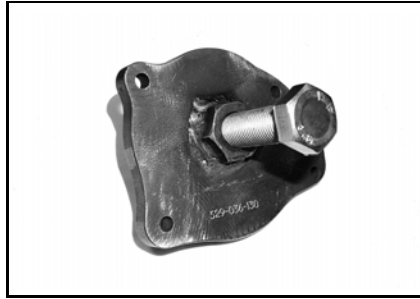

Ceramic seal pusher plate
P/N 529 036 130 Recommended
 V-490, V-660 and V-810 engines
 Use with ceramic seal installer 529035766

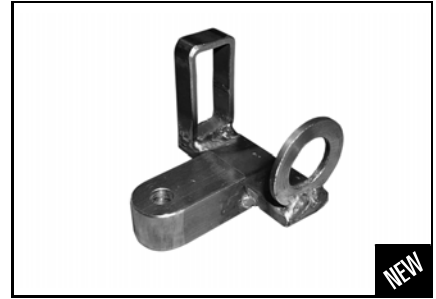

Engine lifting tool
P/N 529 036 131 **Mandatory**
 E-TEC



Dial indicator adaptor
P/N 529 036 132 **Mandatory**
 E-TEC



Piston circlip installer 21mm
P/N 529 036 138 Recommended
 797

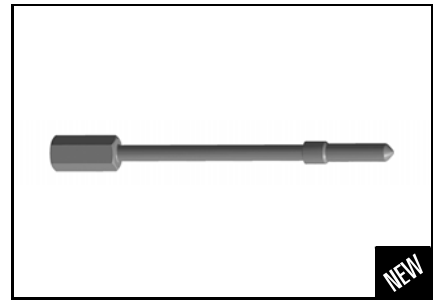

Crankshaft locking bolt
P/N 529 036 148 **Mandatory**
 1203



Camshaft locking tool
P/N 529 036 149 **Mandatory**
 1203

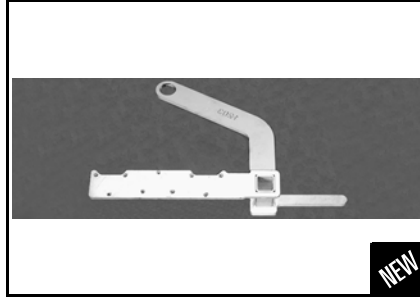

Engine lifting tool
P/N 529 036 151 Recommended
 REV-XR

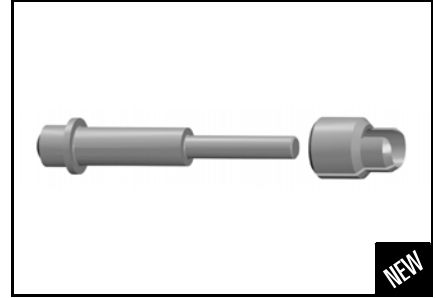

Piston circlip installer
P/N 529 036 153 Recommended
 1203

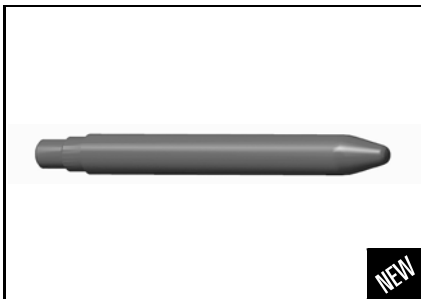

Center bolt
P/N 529 036 154 Recommended
 1203

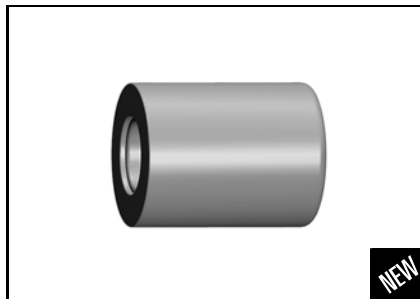

Oil seal installer
P/N 529 036 155 Recommended
 1203



Piston ring compressor
P/N 529 036 156 Recommended
 1203

Engine

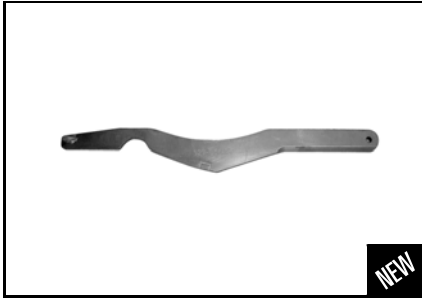

Alignment bar
P/N 529 036 157 **Mandatory**
 REV-XP, XR, XU



Dial indicator adapter
P/N 529 036 159 Recommended
 1203
 Used with 295000143

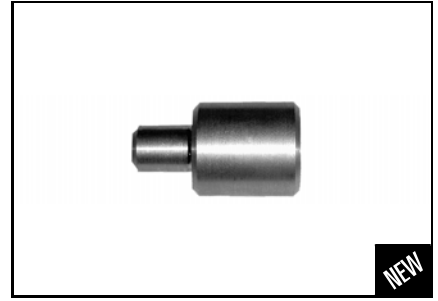

Crankshaft protector (MAG side)
P/N 529 036 160 Recommended
 1203

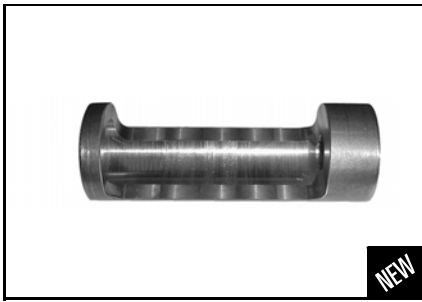

Valve spring compressor cup
P/N 529 036 161 Recommended
 1203

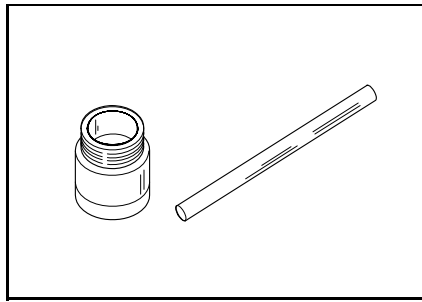

RAVE movement detector
P/N 861 725 800 Recommended
 All RAVE equipped, except 797

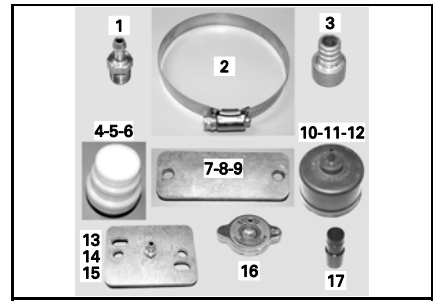

Engine leak test kit
P/N 861 749 100 **Mandatory**
 All
 To use with hand pump 529021800



Piston ring compressor
P/N Snap-on RC 980 Recommended
 4-TEC
 Not sold by BRP

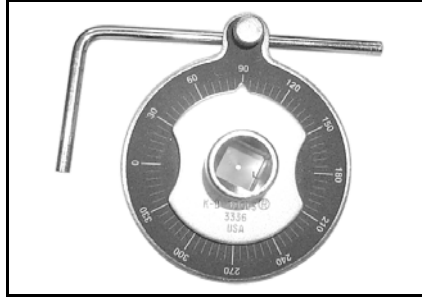

Torque angle gauge
P/N Snap-on TA362 Recommended
 Used on most 4-stroke engines
 Not sold by BRP

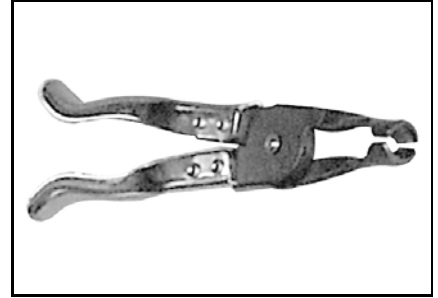

Valve stem seal removal pliers
P/N Snap-on YA 8230 Recommended
 1503, 991 engines, DS650
 Not sold by BRP

Fuel

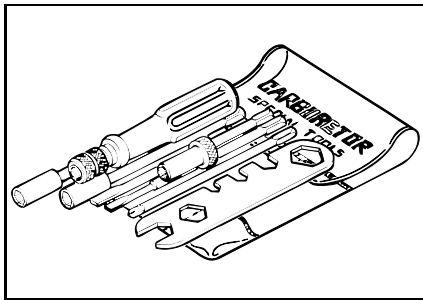

Carburetor tool kit
P/N 404 112 000 Recommended

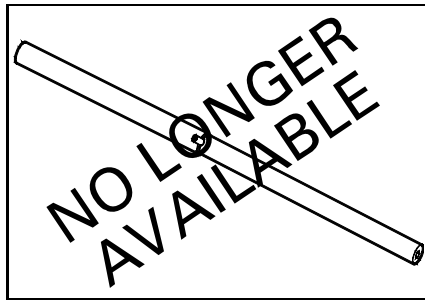

Choke plunger tool
P/N 529 032 100 Recommended
All equipped with choke, except ZX

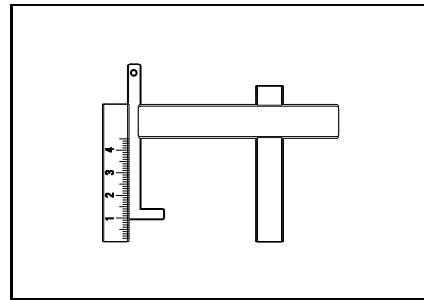

Float level gauge
P/N 529 035 520 Recommended
Carburetor-equipped vehicles



Fuel pressure gauge
P/N 529 035 591 Recommended
787 RFI, 793 SDI and 4-TEC engines
Replaced by 529 035 709. Spare plastic clip
P/N 275500429



Gas tank nut wrench
P/N 529 035 603 Recommended
CK3, ZX



Pressure gauge
P/N 529 035 709 **Mandatory**
Injection type engines
Use with 529035652, 529035714 and
529036023



Disconnect tool
P/N 529 035 714 **Mandatory**
Injection models
Used also with gauge P/N 529 035 709, 529
035 652 and 529 036 023



Needle jet height tool: guide
P/N 529 035 835 Recommended
TM-40 carburetor, 2002-3
Part of kit 590122400



Needle jet height tool: pusher
P/N 529 035 836 Recommended
TM-40 carburetor, 2002-3
Part of kit 590122400



Needle jet height tool: long pusher
P/N 529 035 837 Recommended
TM-40 carburetor, 2002-3
Part of kit 590122400



Needle jet height tool: short pusher
P/N 529 035 838 Recommended
TM-40 Carburetor, 2002-3
Part of kit 590122400



Fuel tank nut wrench
P/N 529 035 891 Recommended
REV, REV-XP, RT and RF

Fuel

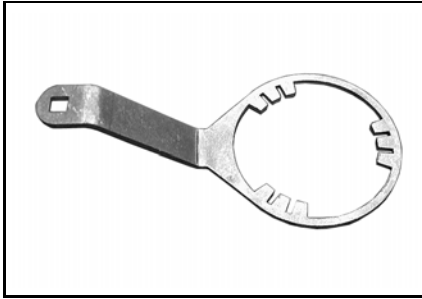

Fuel pump nut tool
P/N 529 035 899 Recommended
 2-TEC SDI and 4-TEC engines

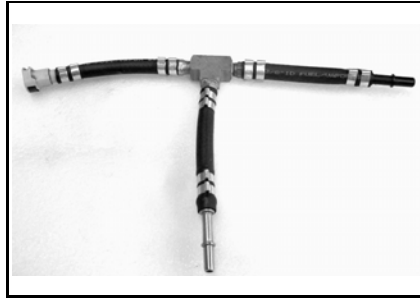

Fuel hose adapter
P/N 529 036 023 **Mandatory**
 Injection type vehicles
 To be used with 529 035 709. Replacement clip 513 033 135

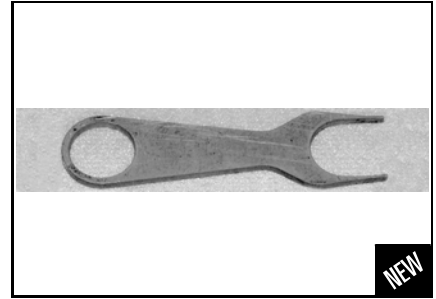

Fuel hose disconnect tool
P/N 529 036 037 Recommended
 1503, 1203
 To disconnect fuel hose.



Fuel pump nut tool
P/N 529 036 118 **Mandatory**
 REV-XP, XR
 For SDI, E-TEC, 1203 and Summit models



Extractor adaptor
P/N 529 036 136 Recommended
 E-TEC, V-twin

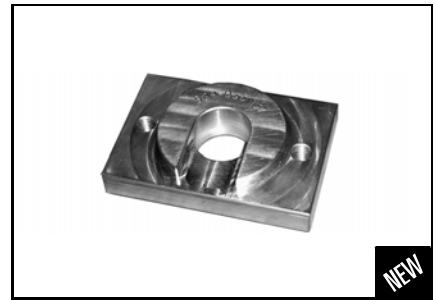

Injector retainer plate
P/N 529 036 137 Recommended
 E-TEC

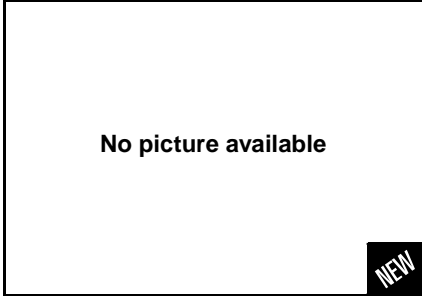

Choke adjuster tool
P/N 529 036 163 Recommended
 Carburetor VM type

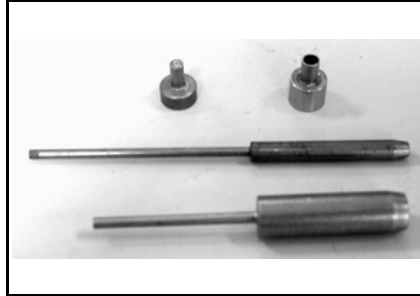

Needle jet height tool kit
P/N 590 122 400 Recommended
 TM-40 carburetor, 2002 and 2003

Cooling

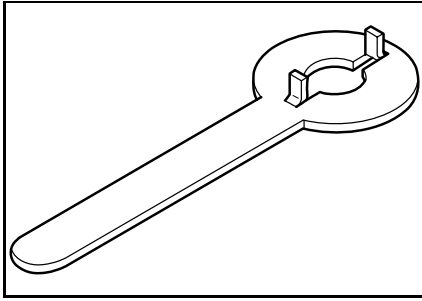

Coolant oil pump gear holder
P/N 420 277 905 Recommended
 717, 583, 670, 599, 699, 779, 809 engine

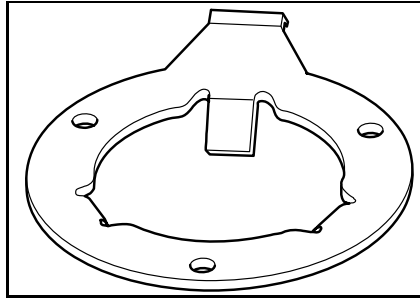

Fan holder wrench
P/N 420 876 357 **Mandatory**
 All axial fan engines
 Except 552F

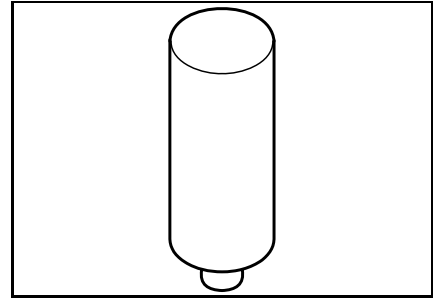

Gasket pusher
P/N 420 876 512 Recommended
 500 LC, 670, 583
 Rotary valve, 10 mm impeller shaft

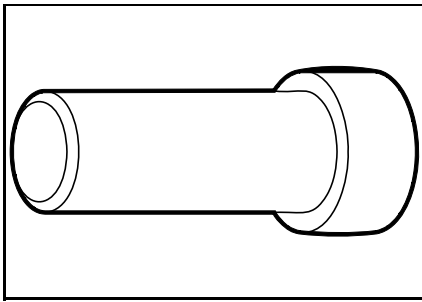

Rotary valve seal pusher
P/N 420 876 607 Recommended
 500lc, 583, 670

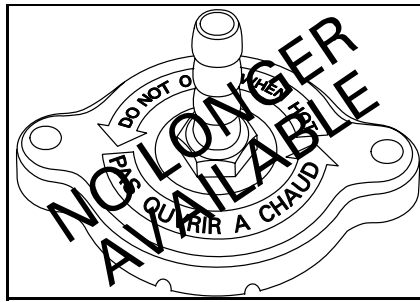

Radiator cap pressure test
P/N 529 021 400 Recommended
 4-TEC models
 Replacement part for item also included in ki
 861749100

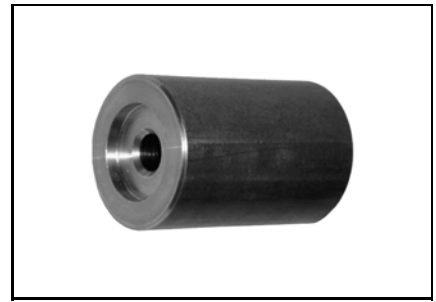

Water pump seal pusher
P/N 529 035 823 Recommended
 4-TEC 1503



Test cap
P/N 529 035 991 Recommended
 All models
 To be used with vacuum/pressure pump 529
 021 800.

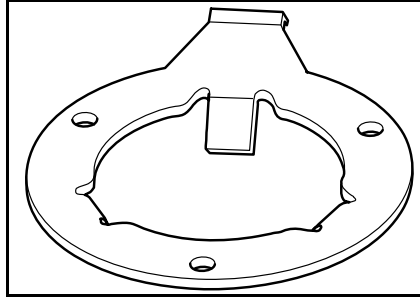

Fan holder tool
P/N 529 036 006 **Mandatory**
 552F

Electrical



MPI communication cables only
P/N 278 001 052 Recommended
 MPI not included

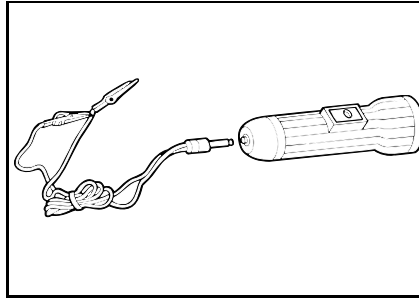

Circuit tester
P/N 414 012 200 Recommended
 All

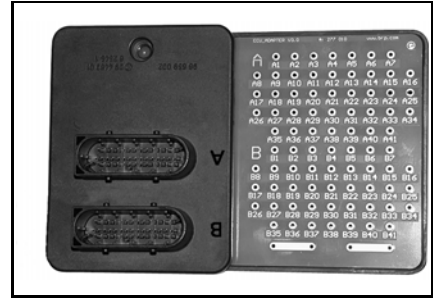

ECM adapter tool
P/N 420 277 010 Recommended
 All models
 All injected 2-TEC & 4-TEC with VDO ECM



MPEM programmer guide
P/N 484 300 139 Recommended
 Guide: how to use hand held programmer
 Has been replaced by B.U.D.S., the MPI
 and recently by the MPI-2.

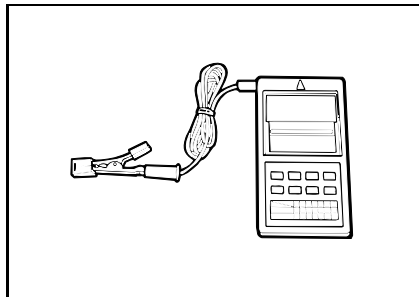

Digital induction tachometer
P/N 529 014 500 Recommended
 All models



Stroboscopic timing light
P/N 529 031 900 Recommended
 All 2-stroke



Bypass wire
P/N 529 033 300 Recommended
 CK3 with magneto 360 W



Adaptor
P/N 529 033 800 Recommended
 GT SE 1997-8 and Summit X 670 1998



Choke nut removal tool
P/N 529 034 600 Recommended
 Replaced by 529035943



Adaptor
P/N 529 035 550 Recommended
 1998, Summit 670 DPM

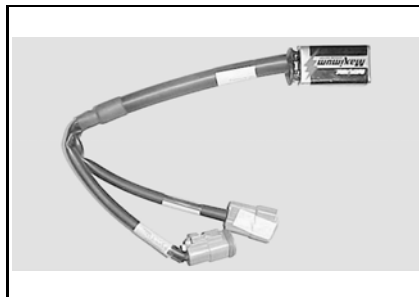

9 V battery supply cable
P/N 529 035 675 **Mandatory**
 All DESS equipped
 Used with 529035869



MPI communication Kit
P/N 529 035 676 Recommended
 Replaced by MPI-2

Electrical



Diagnostic adaptor for VCK
P/N 529 035 679 Recommended
 To be used with the MPI, connects to 529 035 807.

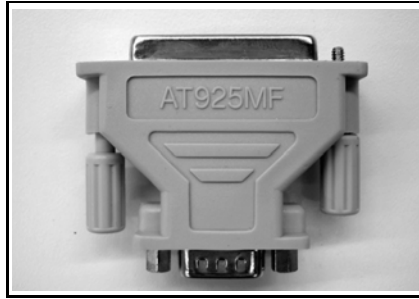

9 pins to 25 pins adaptor
P/N 529 035 681 Recommended
 To connect communication cable P/N 529 035 697 of MPI to older PC.



MPI-2 communication cable extension
P/N 529 035 697 Recommended
 Male/female DB9 extension can be purchased at any PC store; max. 25 ft lg.



Crimping tool (heavy gauge wire)
P/N 529 035 730 Recommended
 All models
 Ex.: To crimp battery cable terminals.



Magneto puller
P/N 529 035 748 Recommended
 All V-twin



Multilock 070 die
P/N 529 035 828 Recommended
 For small connectors of AMP Multilock co
 To use with crimping tool P/N 529035909



Fluke 115 multimeter
P/N 529 035 868 Recommended
 All models

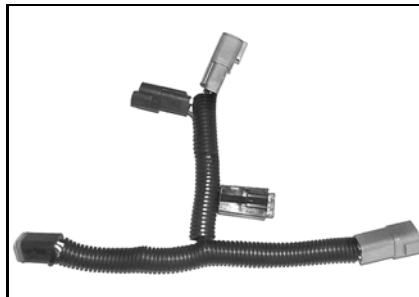

T-harness
P/N 529 035 869 **Mandatory**
 All D.E.S.S. equipped



MPEM programmer kit
P/N 529 035 878 Recommended
 All 2-stroke models
 No longer sold, replaced by MPI-2, P/N 529 036 018.



B.U.D.S. D.E.S.S. Key
P/N 529 035 896 Recommended
 MY 2004 with D.E.S.S.
 To wake up MPEM



D.E.S.S. adaptor
P/N 529 035 904 **Mandatory**
 Connects to the diagnostic cable of the MPI or MPI-2.



Kostal Die
P/N 529 035 906 Recommended
 All models with Kostal ECM connectors
 To use with crimping tool 529 035 909 to crimp ECU connectors

Electrical

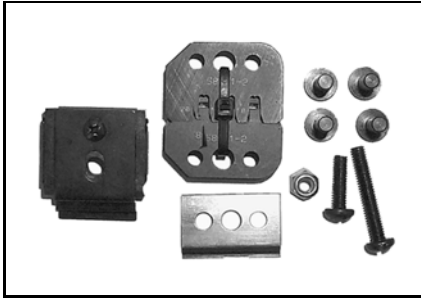

AMP die
P/N 529 035 908 Recommended
 All models with AMP connectors
 To use with crimping tool 529 035 909 to crimp Deutsch connectors.

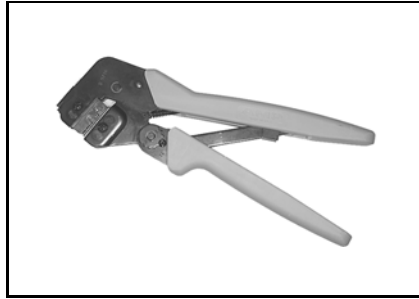

Crimping tool (Kostal)
P/N 529 035 909 Recommended
 To use with compatible die to crimp different connectors

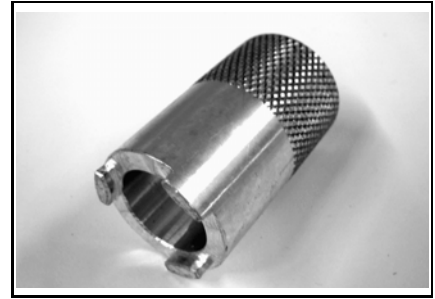

D.E.S.S. Post Remover
P/N 529 035 943 Recommended
 All D.E.S.S. equipped models



MPI communication kit
P/N 529 035 981 Recommended
 Spare cables are still available. See MPI-2

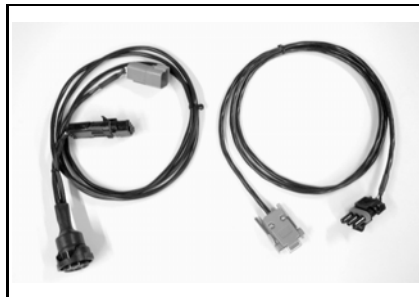

Handheld MEM programmer cable
P/N 529 035 993 Recommended
 6 pin connector.



12 V battery supply cable
P/N 529 035 997 Recommended
 Used with 529035869

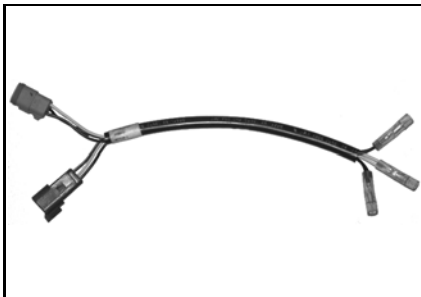

3-pin magneto harness adapter
P/N 529 036 016 Recommended
 1503, 449
 To test the magneto.



MPI-2 interface card
P/N 529 036 018 **Mandatory**
 Replaces the MPI.

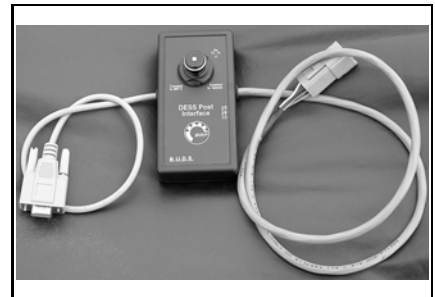

D.E.S.S. post interface
P/N 529 036 019 **Mandatory**
 To programm D.E.S.S. keys with the MPI-2.

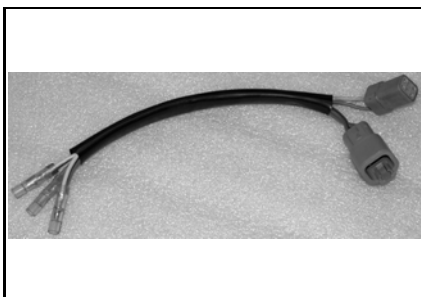

4-pin magneto diagnostic harness
P/N 529 036 062 Recommended
 V810

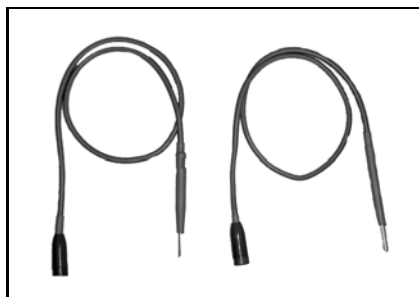

Back probe test wires
P/N 529 036 063 Recommended
 All models
 To back probe various connectors.



Ignition timing tool
P/N 529 036 129 Recommended
 REV-XP

NEW

Electrical



Ignition timing tool 500/600

P/N 529 036 143 Recommended
REV-XP



MPI-2 diagnostic cable

P/N 710 000 851 **Mandatory**
All D.E.S.S. equipped vehicles

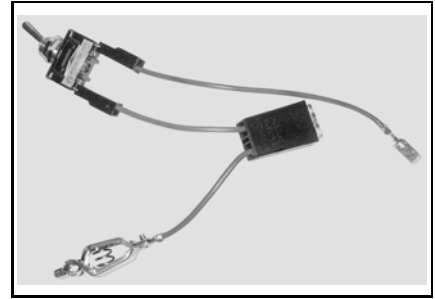

Bypass wire kit

P/N 861 780 600 Recommended
2002 ZX 360 W magneto

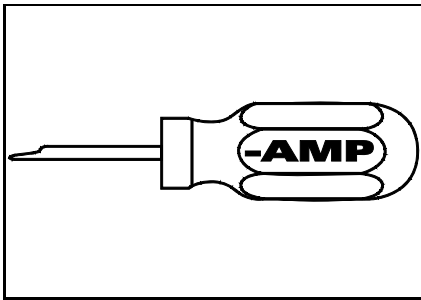

Multilock terminal extraction tool

P/N AMP 755430-2 Recommended
Not sold by BRP

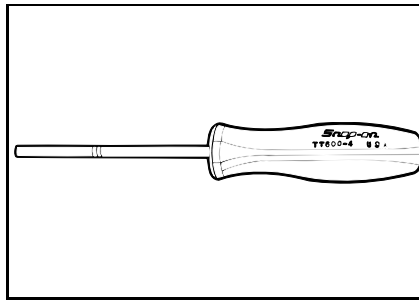

Packard terminal extractor

P/N Snap-on TT600-4 Recommended
Not sold by BRP

Lubrication



Adapter hose

P/N 529 035 652 Recommended
4-stroke engines
Used with 529 035 709.

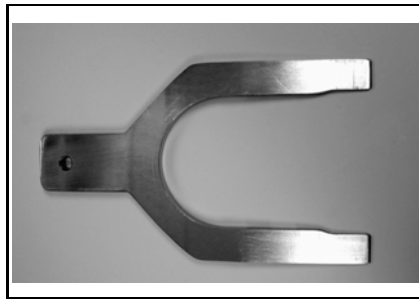

Oil filter cover extractor

P/N 529 036 038 Recommended
4-TEC 1503

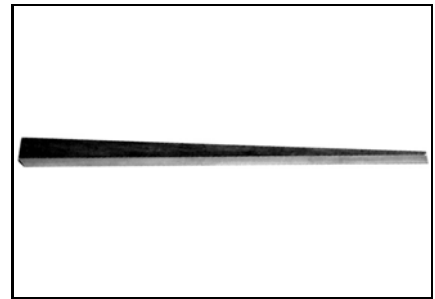

Distance gauge

P/N 529 036 042 Recommended
Replacement part for 861205900

Lubrication



Oil pump adjustment procedure card
P/N 529 036 043 Recommended
 Replacement part for 861205900

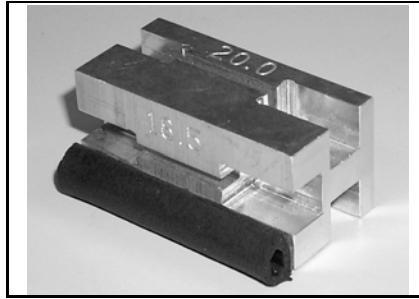

Oil pump cable jig
P/N 529 036 045 Recommended
 Replacement part for 861205900



Oil filter cover puller
P/N 529 036 057 Recommended
 4-TEC 1503
 Replaced by 529 036 108.

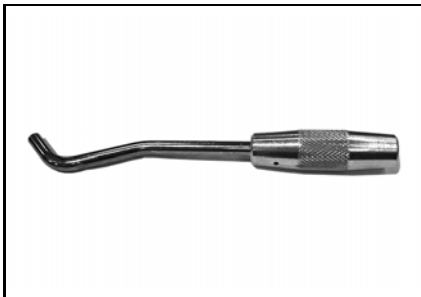

Oil filter cover puller
P/N 529 036 108 Recommended
 1503
 Used with 529 036 038.

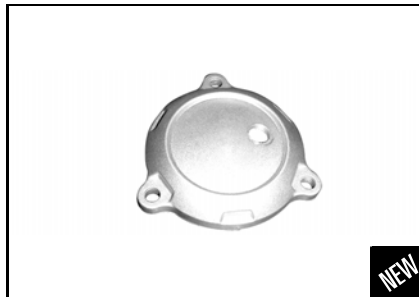

Oil pressure test cap
P/N 529 036 158 Recommended
 1203
 used with 529035652 and 529035709



Oil pump adjustment kit
P/N 861 205 900 **Mandatory**
 2005 and up LC engines

Transmission / Propulsion

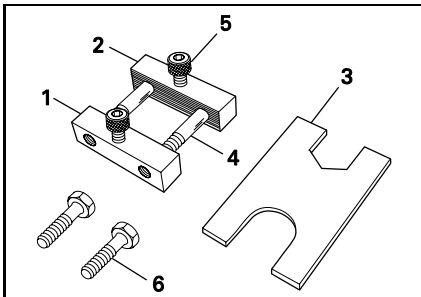

M10 bolt (item 4)
P/N 222 007 565 Recommended
 All except Élan
 Part of kit 861725700

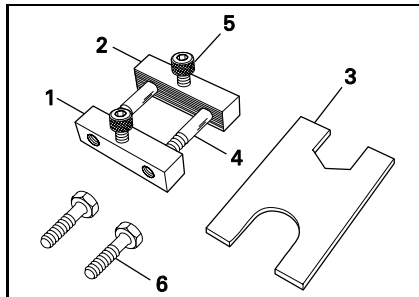

M8 screw (item 6)
P/N 222 082 565 Recommended
 All except Élan
 Part of kit 861725700

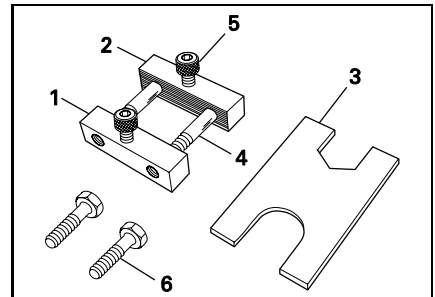

Allen screw (item 5)
P/N 222 983 065 Recommended
 All except Élan
 Part of kit 861725700

Transmission / Propulsion



Tensiometer

P/N 414 348 200

Mandatory

All

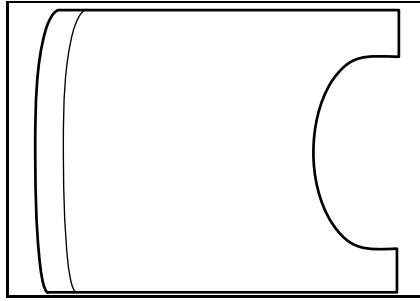

Alignment tool

P/N 420 476 010

Recommended

Skandic WT and Alpine II gearbox

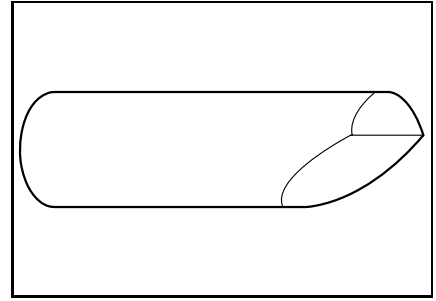

Transmission ball mounting pin

P/N 420 476 020

Recommended

Alpine II gearbox

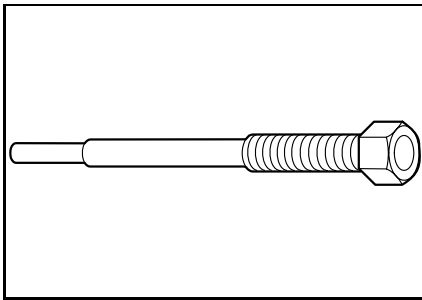

Driven pulley puller (SAE threads)

P/N 529 002 100

Recommended

Square shaft equipped vehicles

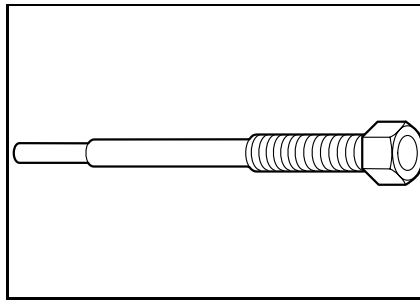

Driven pulley puller (metric threads)

P/N 529 002 800

Recommended

277-377

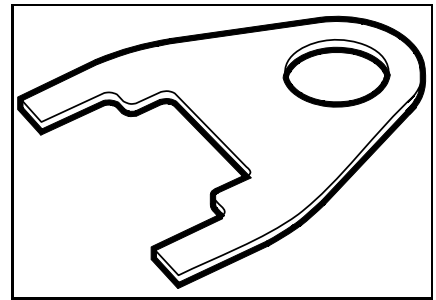

Slider shoe fork

P/N 529 005 500

Mandatory

All vehicles with TRA drive pulley



Drive pulley holder (CVT)

P/N 529 006 400

Recommended

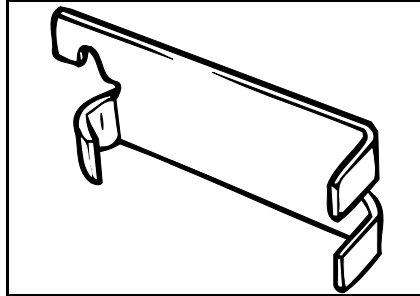

Spring scale hook

P/N 529 006 500

Recommended

Tundra II LT

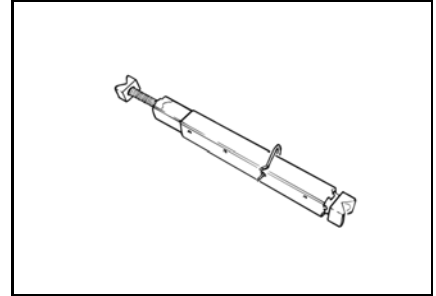

Drive axle holder

P/N 529 007 200

Recommended

All

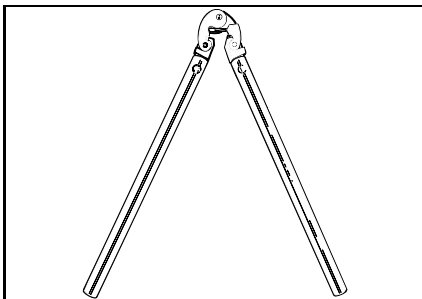

Track wide cleat installer

P/N 529 007 700

Recommended

1992 and older with wide cleat

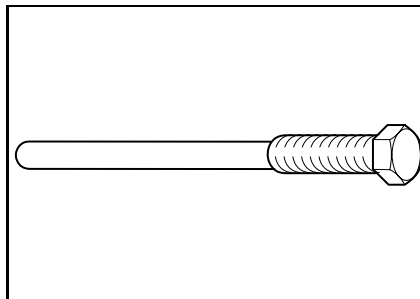

Drive pulley puller

P/N 529 007 900

Mandatory

443, 467, 503, 536 and 537 TRA

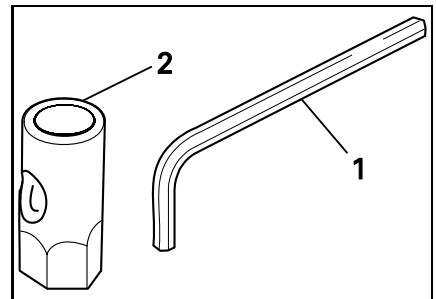

Drive belt tension adjuster

P/N 529 008 700

Recommended

Formula and LPV 27 driven pulley
1: 420878730, 2: 529015000; available as a kit only.

Transmission / Propulsion

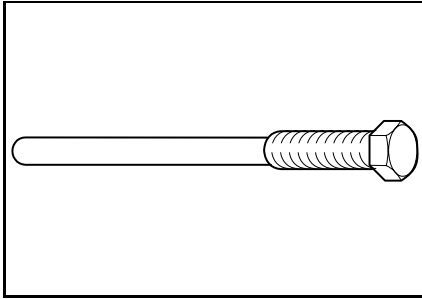

TRA drive pulley puller (27 mm)
P/N 529 010 100 Recommended
 TRA (27 mm) except 454, 670 and 779

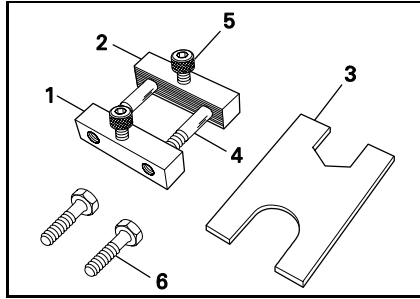
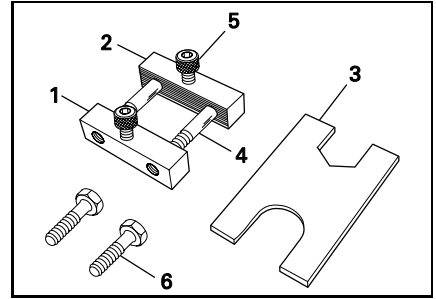
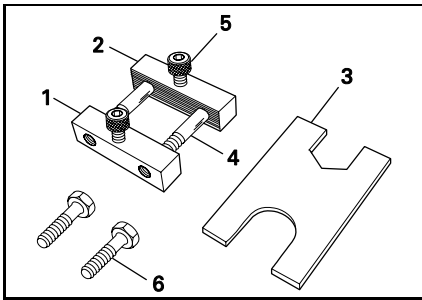

Plate (item 3)
P/N 529 010 600 Recommended
 All except Élan
 Part of kit 861725700



Block with threads (item 1)
P/N 529 010 700 Recommended
 All except Élan
 Part of kit 861725700



Block without threads (item 2)
P/N 529 010 800 Recommended
 All except Élan
 Part of kit 861725700

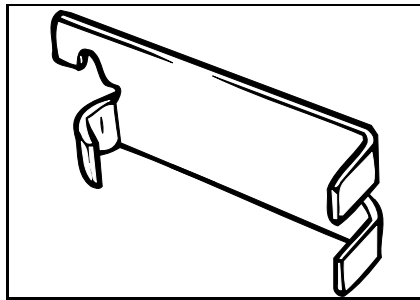

Spring scale hook
P/N 529 015 200 Recommended
 1994 models and older, except Alpine II

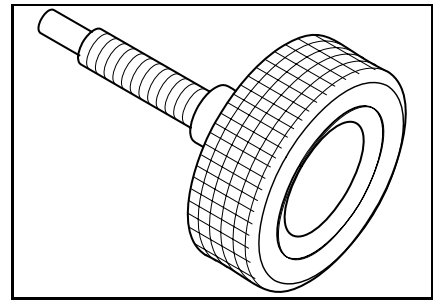

Driven pulley opening tool
P/N 529 017 200 Recommended
 Almost all models



Drive pulley puller
P/N 529 022 400 **Mandatory**
 2003 and up Bombardier Lite and TRA

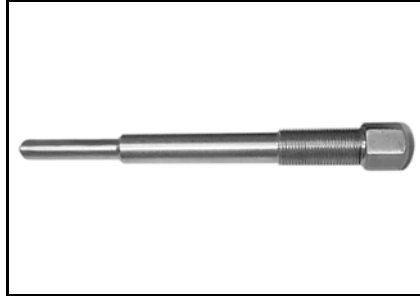

Drive pulley puller
P/N 529 025 000 Recommended
 Skandic 440 LT

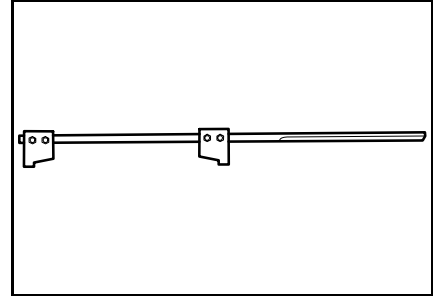

Pulley alignment bar
P/N 529 026 700 Recommended
 S-2000, F-2000

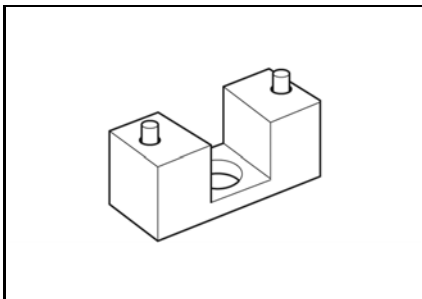

Spring cover puller
P/N 529 027 300 Recommended
 Bombardier Lite

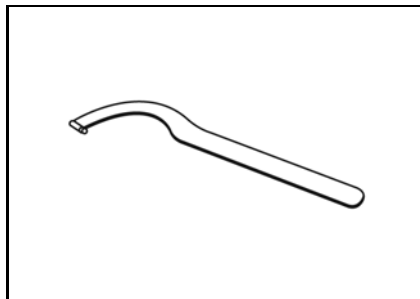

Clutch holder tool
P/N 529 027 600 Recommended
 Bombardier Lite



Track cleat installer
P/N 529 028 800 Recommended
 1994 and newer models
 Replaced by 529036044.

Transmission / Propulsion

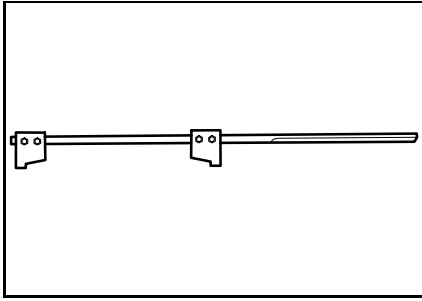

Pulley alignment bar
P/N 529 030 000 Recommended
 S series with Bombardier LITE

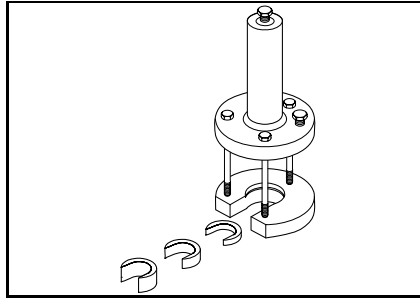

Countershaft bearing remover
P/N 529 030 100 Recommended
 F and S series

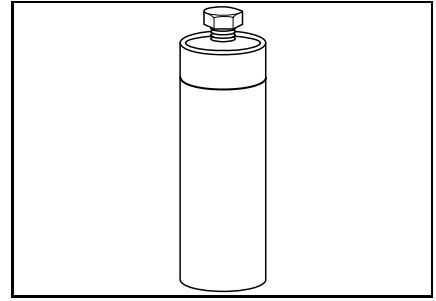

Countershaft bearing installer
P/N 529 030 200 Recommended
 S and F series

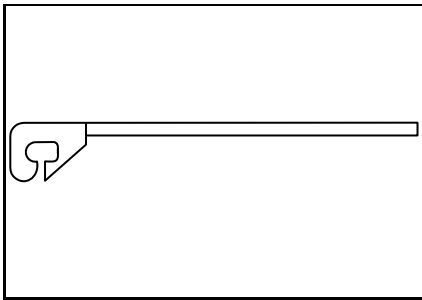

Transmission adjuster
P/N 529 030 300 Recommended
 "Push-pull shifter" reverse transmissio

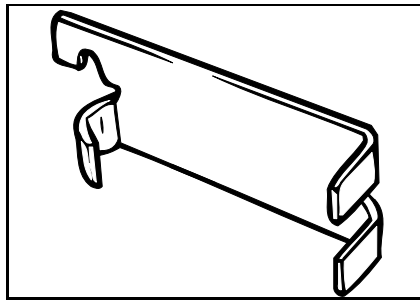

Spring scale hook
P/N 529 030 900 Recommended
 S-2000, F-2000 1995 and newer

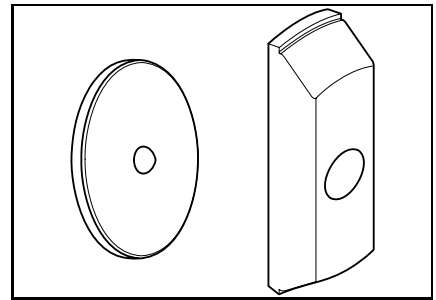

Large bushing extractor
P/N 529 031 100 Recommended
 Formula type driven pulley
 To use with puller: 529018600

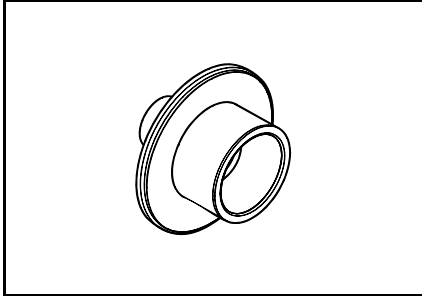

Bushing puller/installer
P/N 529 031 200 Recommended
 All
 Except Tundra R, Skandic WT/SWT/WT
 LC, S series



Bushing extractor/installer
P/N 529 031 300 Recommended
 TRA cover with replacable bushing

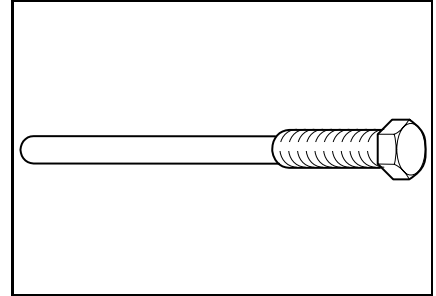

Drive pulley puller
P/N 529 031 400 Recommended
 277F, 377F
 2002 and older Bombardier Lite equipped
 vehicles

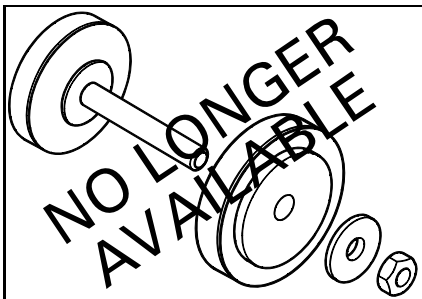

Chaincase seal pusher
P/N 529 032 300 Recommended
 Replaced by 529035584



Driven pulley opening tool
P/N 529 034 200 Recommended
 Tundra R up to 2005



Driven pulley spring compressor
P/N 529 035 300 Recommended
 Tundra R

Transmission / Propulsion

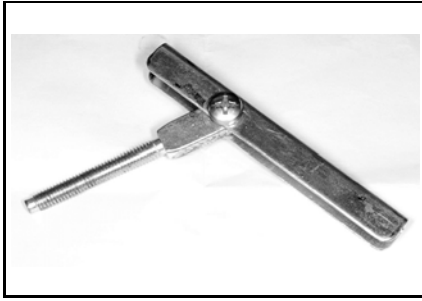

Driven pulley opening tool
P/N 529 035 501 Recommended
 HPV, LPV and some Formula pulley

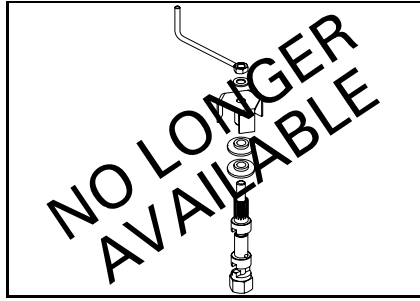

Pulley spring compressor
P/N 529 035 524 Recommended
 All
 This tool has been replaced by 529036012

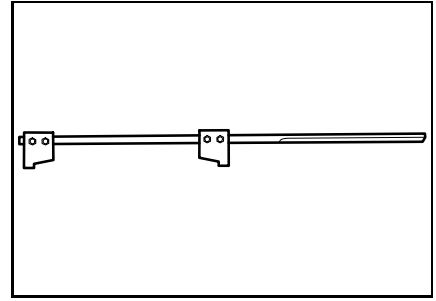

Pulley alignment bar
P/N 529 035 527 Recommended
 CK3 except Mach Z 1998

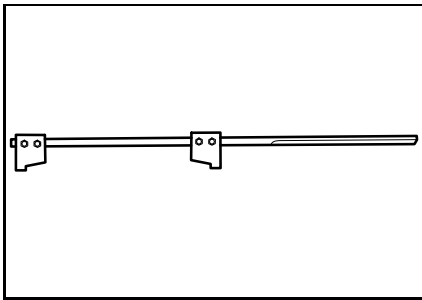

Alignment bar
P/N 529 035 530 Recommended
 S-2000 with TRA and RER

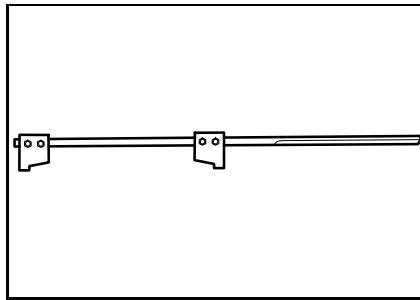

Pulley alignment bar
P/N 529 035 545 Recommended
 1998 Skandic WT

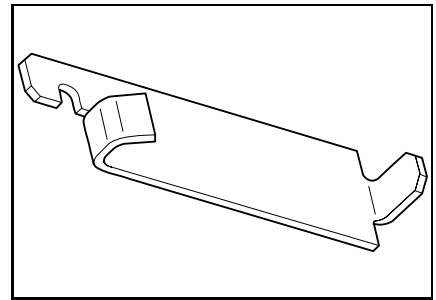

Spring scale hook (long)
P/N 529 035 557 Recommended
 CK3 without RER

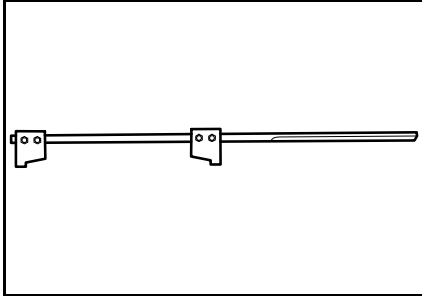

Pulley alignment bar
P/N 529 035 572 Recommended
 1998 Mach Z

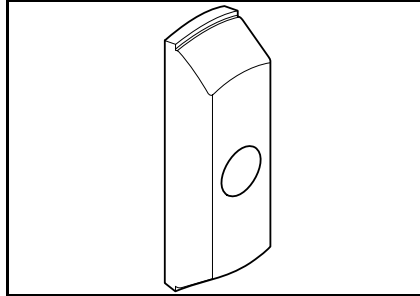

Large bushing extractor
P/N 529 035 575 Recommended
 LPV27 driven pulley
 To be used with 529035524

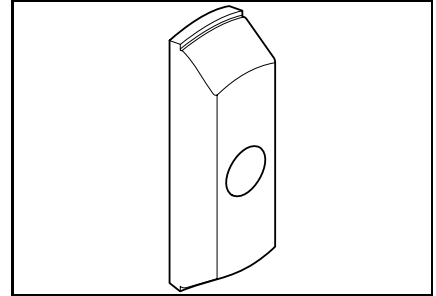

Large bushing extractor
P/N 529 035 576 Recommended
 Formula type driven pulley
 To be used with 529035524

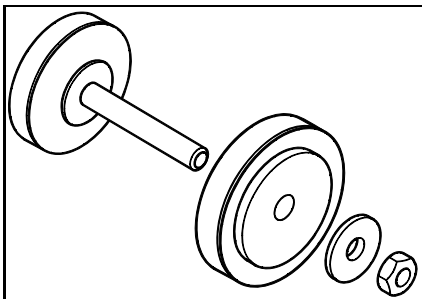

Chaincase seal pusher
P/N 529 035 584 Recommended
 All Frames
 Replaces 529032300

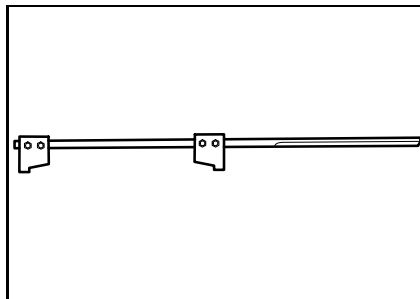

Pulley alignment bar
P/N 529 035 586 Recommended
 S and ZX series

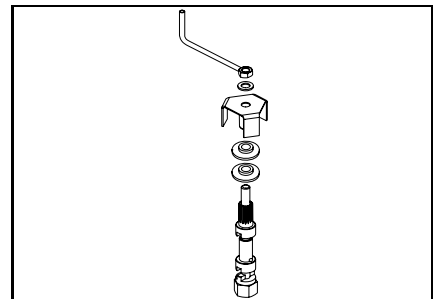

Replacement part for puller
P/N 529 035 588 Recommended
 For 529036012

Transmission / Propulsion

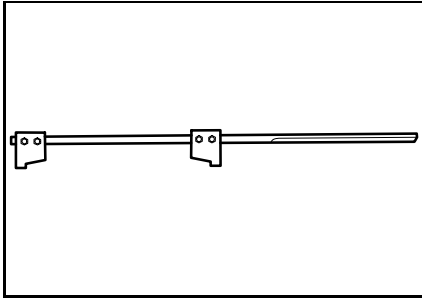

Pulley alignment bar
P/N 529 035 594 Recommended
 CK3 series

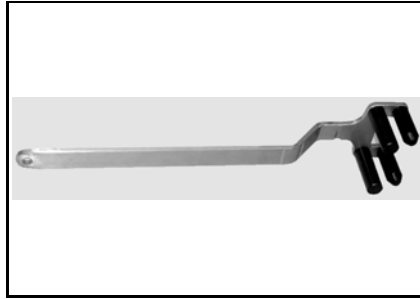

Drive pulley holder
P/N 529 035 674 **Mandatory**
 All TRA

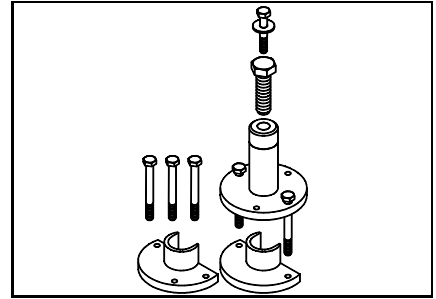

Countershaft bearing remover/installer
P/N 529 035 699 Recommended
 REV, RT, ZX and CK3
 Replaces 529035554.

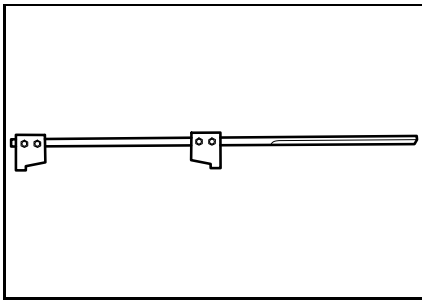

Pulley alignment bar
P/N 529 035 808 Recommended
 Skandic II



Countershaft bearing remover
P/N 529 035 812 Recommended
 Skandic LT

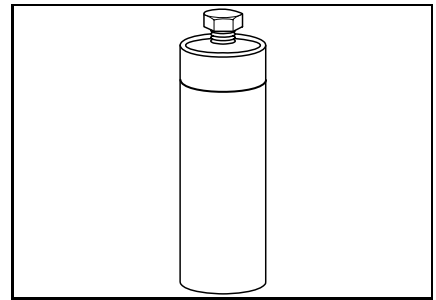

Bearing pusher
P/N 529 035 815 Recommended
 Skandic 440 LT



Tapered tool
P/N 529 035 826 Recommended
 Skandic 440 LT
 Replacement tool from kit 529025400

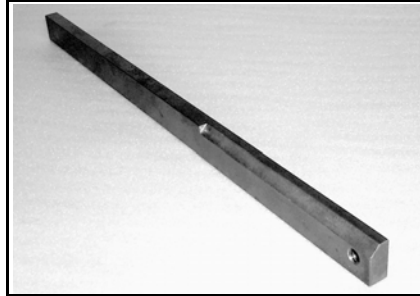

Universal alignment bar
P/N 529 035 831 **Mandatory**
 All except CK3 and ELITE

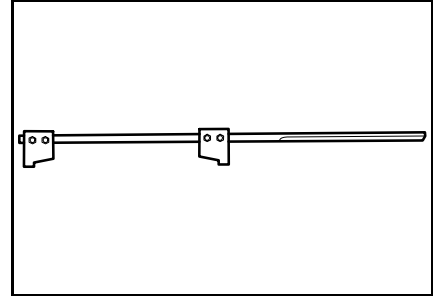

Pulley alignment bar
P/N 529 035 832 Recommended
 ZX series



Gouvernor cup remover
P/N 529 035 894 Recommended
 TRA IV



Bushing remover/installer
P/N 529 035 931 Recommended
 TRA III and TRA IV

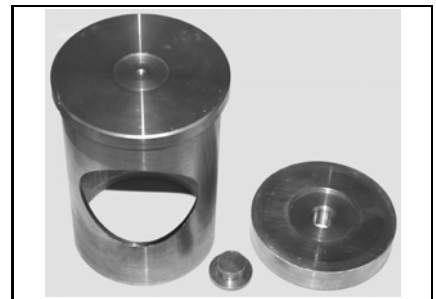

Hydraulic gauge kit
P/N 529 035 939 Recommended
 TRA IV

Transmission / Propulsion

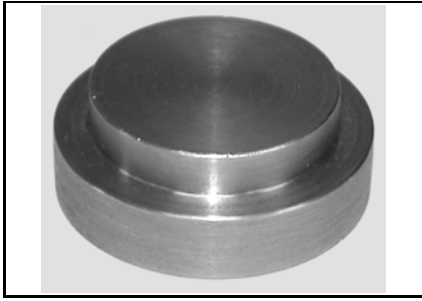

Clutch support
P/N 529 035 942 Recommended
 TRA IV

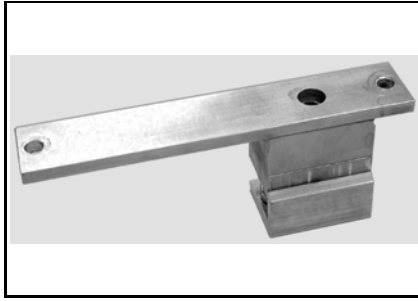

Belt tensioner tool
P/N 529 035 957 Recommended
 Elite

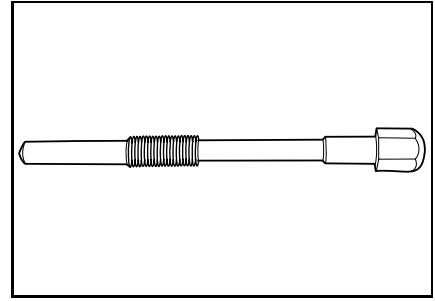

Clutch puller
P/N 529 035 959 Recommended
 Elite

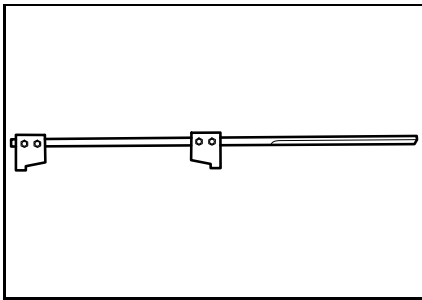

Pulley alignment bar
P/N 529 035 974 Recommended
 2004 Skandic WT/SWT/SUV 550

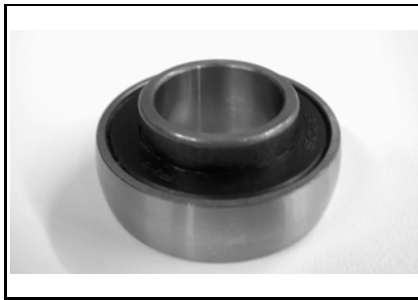

Countershaft measurement tool
P/N 529 036 009 Recommended
 RT



Countershaft bearing remover/installer b
P/N 529 036 010 Recommended
 RT, DS 450

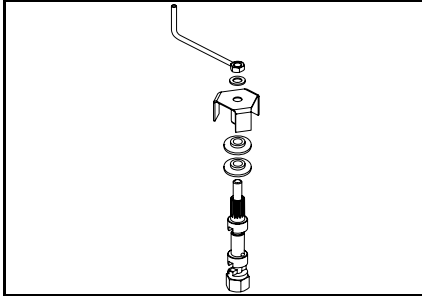

Pulley spring compressor tool
P/N 529 036 012 **Mandatory**
 Most drive and driven pulleys



Driven spring compressor
P/N 529 036 035 Recommended
 RF 277F 2006 only
 To take apart the driven

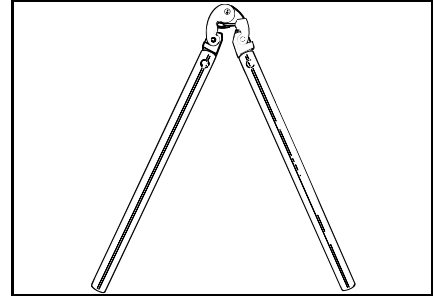

Track cleat installer
P/N 529 036 044 Recommended
 1994 and newer models
 Stronger version of tool 529028800. For newer track design.

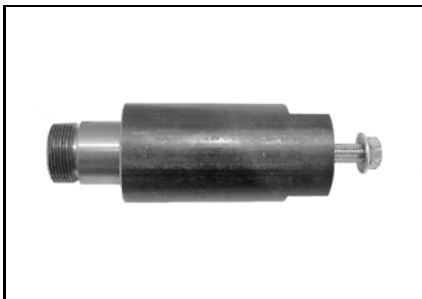

Driven pulley spring compressor
P/N 529 036 064 **Mandatory**
 REV-XP

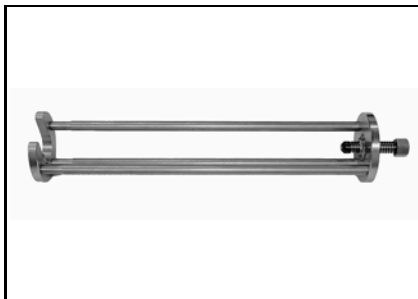

Countershaft bearing remover
P/N 529 036 065 **Mandatory**
 REV-XP

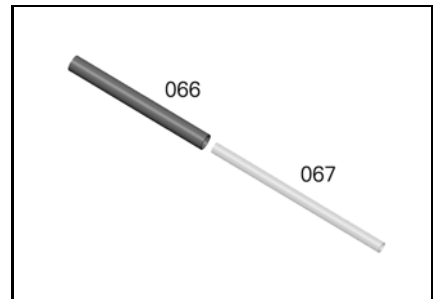

Countershaft bearing installer
P/N 529 036 066 **Mandatory**
 REV-XP

Transmission / Propulsion

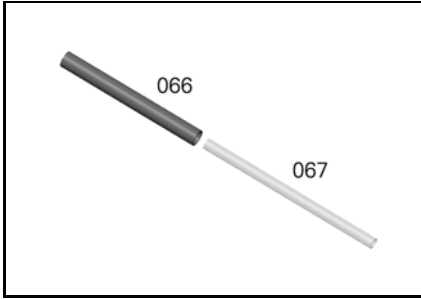

Countershaft support
P/N 529 036 067
REV-XP

Mandatory

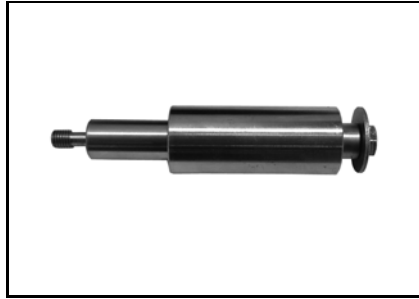

Upper gear retaining tool
P/N 529 036 110
REV-XP

Mandatory

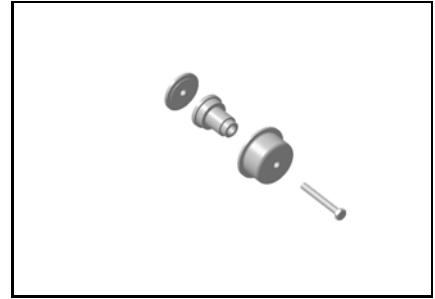

Bearing puller/pusher
P/N 529 036 111
REV-XP

Mandatory

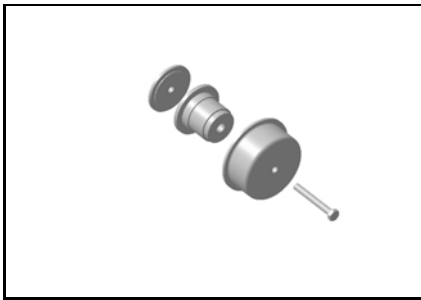

Bearing puller/pusher
P/N 529 036 112
REV-XP

Mandatory



Screw cap socket
P/N 529 036 122
600 RS

Recommended



Driven pulley opening tool
P/N 529 036 127
REV-XP

Recommended



Caliper puller
P/N 529 036 145
REV-XP

Mandatory

NEW



Drive shaft protector cap
P/N 529 036 146
REV-XP

Mandatory

NEW



QRS hub torquing tool
P/N 529 036 147
REV-XP/XR

Recommended

NEW

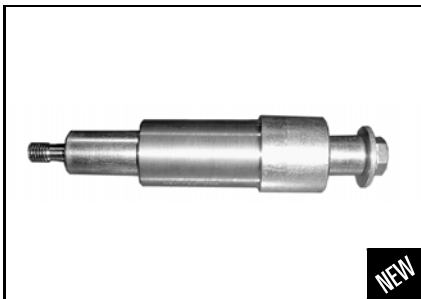

Chaincase gear retaining tool
P/N 529 036 152
XR

Recommended

NEW

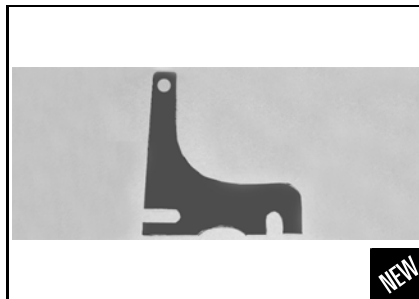

Preload tester
P/N 529 036 164
REV-XR

Recommended

NEW



Countershaft retaining tool
P/N 529 036 165
REV-XP, XR, XU

Recommended

NEW

Transmission / Propulsion

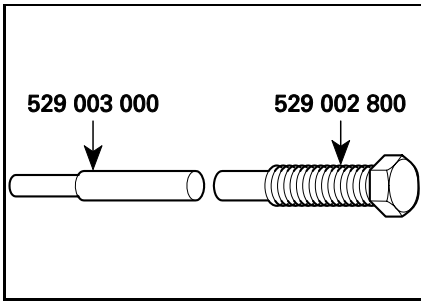

Drive pulley puller

P/N 860 414 200 Recommended
 Square shaft equipped vehicles (metric)
 Made of 529003000 & 529002800

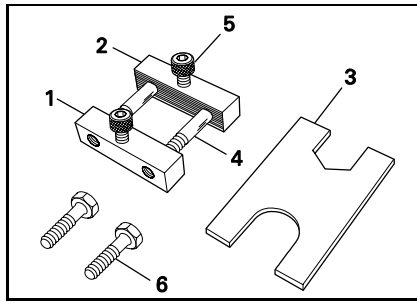

Drive axle sprocket adjuster kit

P/N 861 725 700 Recommended
 All except Élan
 Includes: 529010700, 529010800,
 529010600, 222007565, 222983065 &

Brake

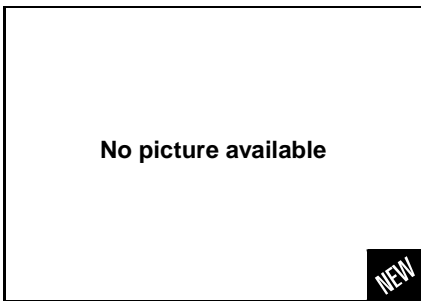

Protective cap

P/N 529 036 150 Recommended
 REV-XP, REV-XR

Steering



Heated grip installer

P/N 529 035 897 Recommended
 Straight grips



Heated grip installer

P/N 529 035 936 Recommended
 Models with J-hooks

Suspension

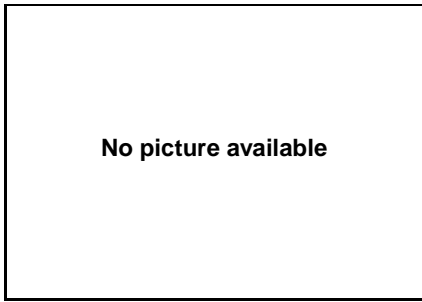

Gas fill tool kit
P/N 503 190 102 Recommended
 T/A shocks
 To be used with P/N 529035570. Spare
 needle P/N 529035930.

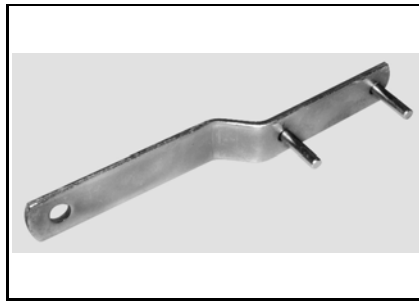

Suspension adjustment wrench
P/N 520 000 126 Recommended
 SC-10 II and III



Ball joint installer
P/N 529 000 012 **Mandatory**
 REV, RT, DS 650, DS 450

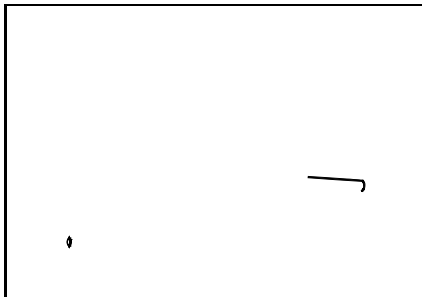

Spring installer
P/N 529 005 000 Recommended
 Rear suspension torsion spring removal

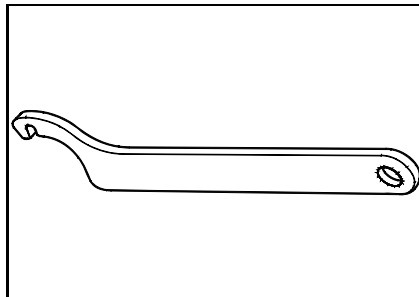

Suspension adjustment tool
P/N 529 017 100 Recommended
 1992 and older C-7

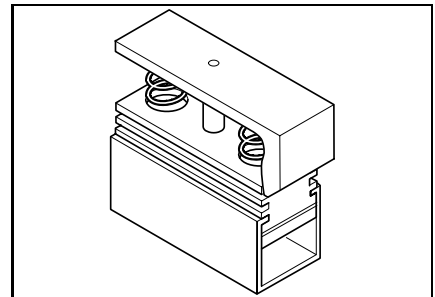

Track tension adjuster
P/N 529 021 500 Recommended
 All except Élan

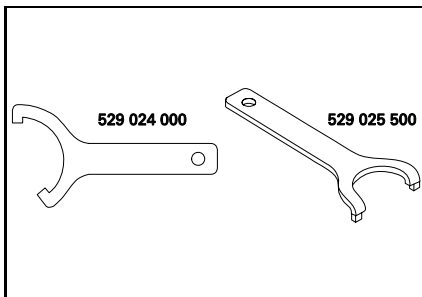

Suspension adjustment wrench
P/N 529 024 000 Recommended
 1998 and older models, with T/A shock
 Included in kit 861743900

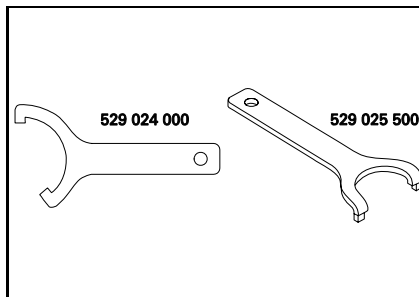

Suspension adjustment wrench
P/N 529 025 500 Recommended
 1998 and older models with T/A shock
 Included in kit 861743900

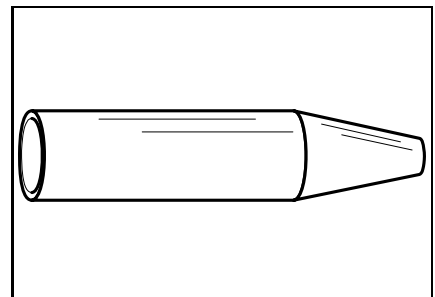

Dome guide
P/N 529 026 500 Recommended
 C-36 HPG T/A Shock

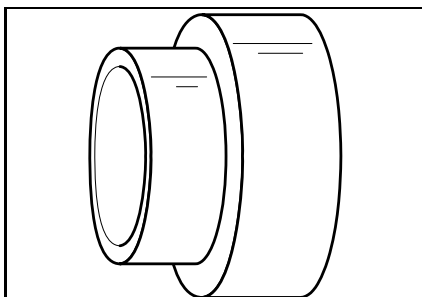

Piston guide
P/N 529 026 600 Recommended
 C-36 HPG T/A shock

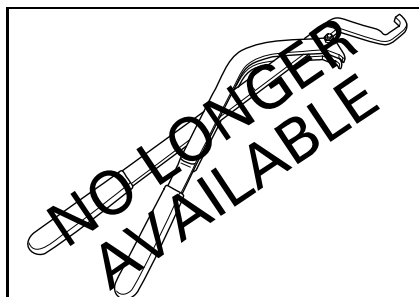

Track cleat remover
P/N 529 028 700 Recommended
 1994 and newer, except Élan & Tundra II



Shock preload adjustment wrench
P/N 529 032 900 Recommended

Suspension

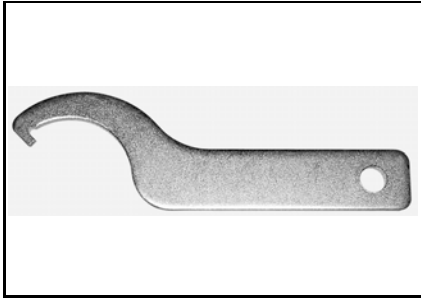

Suspension adjustment tool
P/N 529 034 100 Recommended
 CK3 series

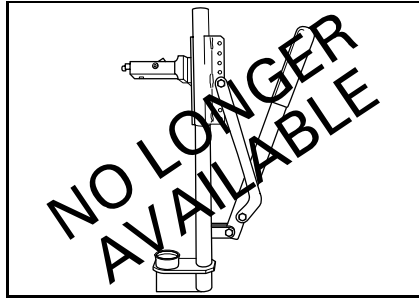

Spring compressor
P/N 529 035 504 Recommended
 No longer sold, replaced by P/N 529 036 007

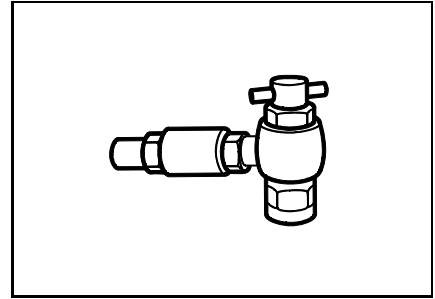

Gas shock valve tool (tire valve type)
P/N 529 035 570 Recommended
 T/A shocks

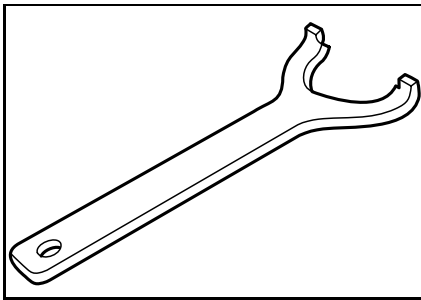

Kayaba shock adjustment wrench
P/N 529 035 582 Recommended
 C-7 suspension

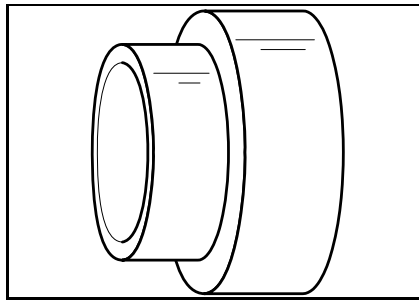

Piston guide
P/N 529 035 608 Recommended
 C-46 HPG T/A shock

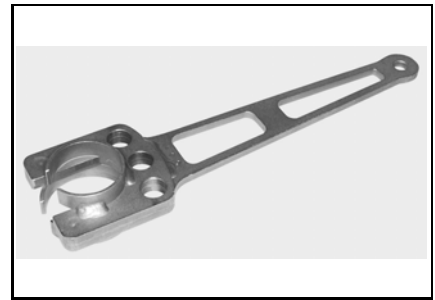

Shock wrench
P/N 529 035 727 Recommended
 All T/A shocks

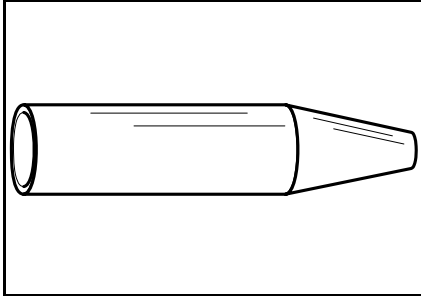

Dome guide
P/N 529 035 728 Recommended
 C-46 HPG T/A shocks

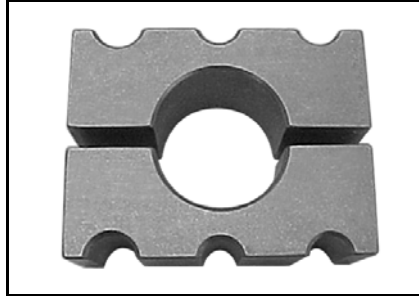

Shock retainer tool
P/N 529 035 769 Recommended
 All HPG shock



Ball joint extractor
P/N 529 035 827 **Mandatory**
 REV, RT



Ball joint remover support
P/N 529 035 873 **Mandatory**
 REV, RT
 Replaced by 529036121



Ball joint installer
P/N 529 035 874 Recommended
 2003 REV series



Ball joint installer support
P/N 529 035 875 **Mandatory**
 REV, RT, Outlander

Suspension

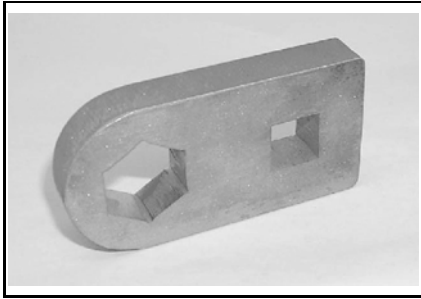

A-arm nut wrench
P/N 529 035 876
REV, RT

Mandatory

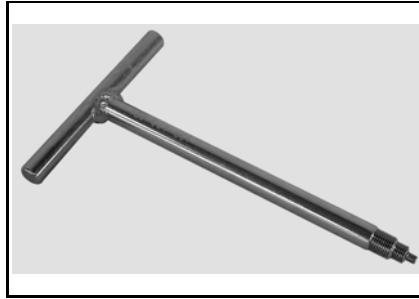

Floating piston puller
P/N 529 035 901
HPG T/A shock with external reservoir

Recommended

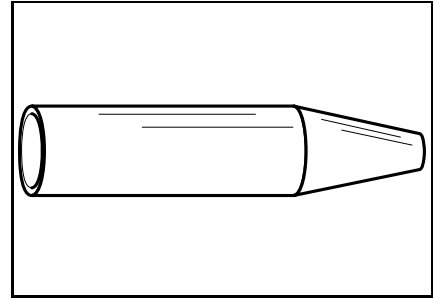

Dome guide
P/N 529 035 902
ZX X 440

Recommended



Floating piston support
P/N 529 035 903
ZX X 440

Recommended

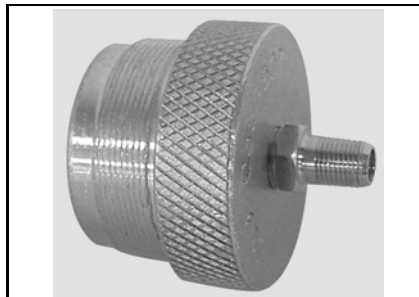

Floating piston puller
P/N 529 035 907
MX Z X 440

Recommended



Needle (10) spare
P/N 529 035 930
Used with 503190102

Recommended



Ball joint lock
P/N 529 035 945
REV, RT

Recommended



Ball joint installer
P/N 529 035 975
REV, RT, except 2003 REV

Recommended



Spring remover
P/N 529 036 007
All models
To remove coil spring from shock.

Recommended



Ball joint remover support
P/N 529 036 121
REV, RT, Outlander, roadsters

Recommended

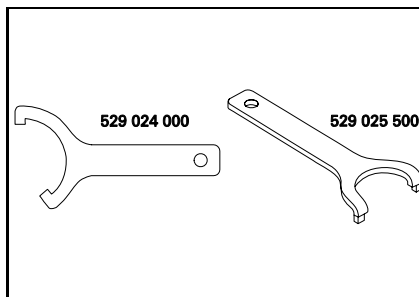

Suspension adjustment wrench
P/N 861 743 900
1998 and older models with T/A shocks
Includes 529024000 & 529025500

Recommended

Body



Template for hood drilling

P/N 529 034 400 Recommended

S series

To install gauges.

Various

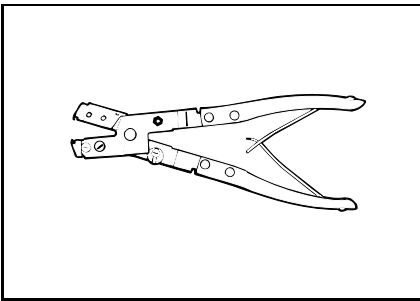

Oetiker pliers

P/N 295 000 069 Recommended

All models

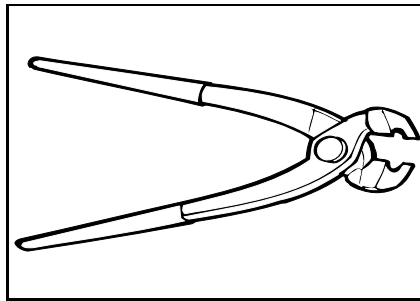

Oetiker pliers

P/N 295 000 070 Recommended

All models

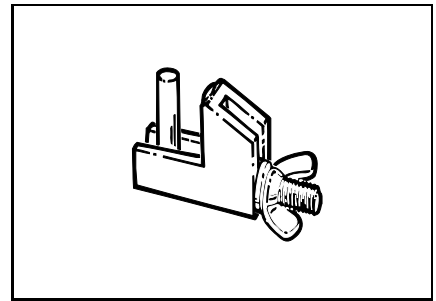

Small hose pincher

P/N 295 000 076

All models

Mandatory



6 mm insert pliers

P/N 295 000 162 Recommended

To install 6 mm inserts on frame.

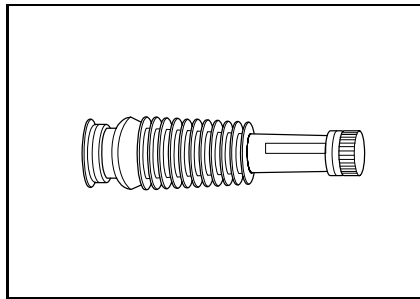

Flexible spout for oil

P/N 414 837 300 Recommended

All models

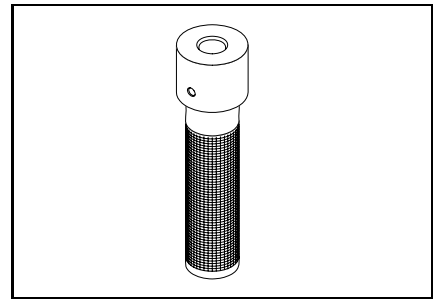

Handle

P/N 420 877 650

All models

Can be used with many types of pushers.

Various

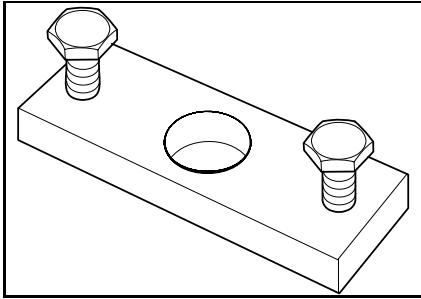

Cam puller
P/N 529 012 900 Recommended
 Tundra II LT

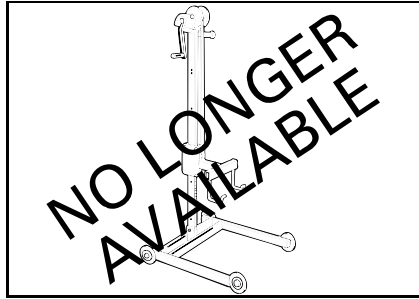

Snowmobile rack
P/N 529 020 000 Recommended
 All
 No longer sold, replacement parts still available.

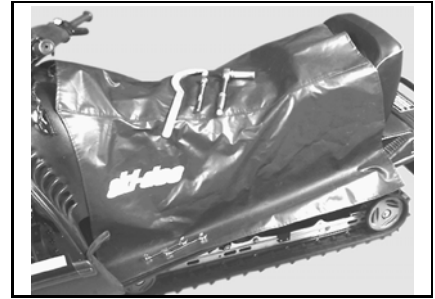

Protective mat
P/N 529 030 600 Recommended
 All



Supertitanium drill bit 3/16"
P/N 529 031 800 Recommended
 To drill/remove many kinds of rivets.

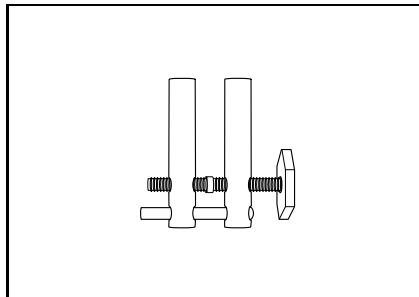

Large hose pincher
P/N 529 032 500 Recommended
 All models

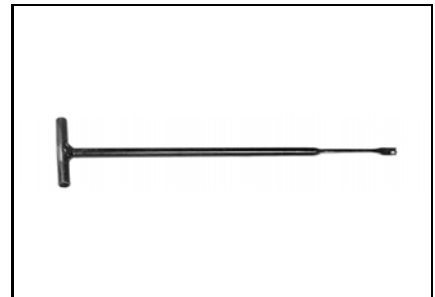

Spring installer/remover
P/N 529 035 983 **Mandatory**
 All models

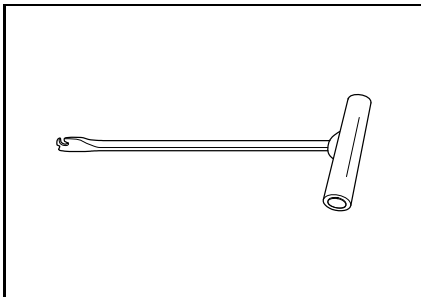

Spring installer/remover (small)
P/N 529 035 989 **Mandatory**



Blind hole bearing puller set
P/N 529 036 117 Recommended
 All models
 Replaced by 529036056

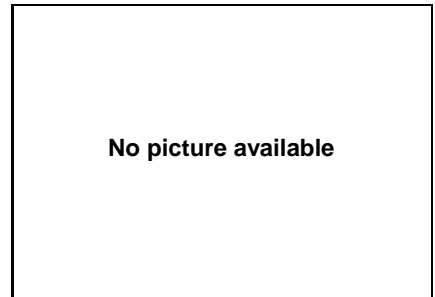

Slide hammer
P/N Snap-on CJ125-6 Recommended
 All
 No sold by BRP

Index

Tool Part Numbers ... Page

These tools are mandatory

222007565	23	420876922	4	529021500	32	529035521	7
222082565	23	420876980	4	529021800	6	529035522	7
222983065	23	420877050	4	529022400	25	529035523	7
278001052	19	420877635	4	529022500	6	529035524	27
295000069	35	420877650	35	529023400	6	529035527	27
295000070	35	420877820	4	529024000	32	529035530	27
295000076	35	420940755	5	529024600	6	529035541	7
295000114	2	420976235	5	529024900	6	529035542	7
295000143	2	420976890	5	529025000	25	529035543	8
295000162	35	420977475	5	529025500	32	529035545	27
404112000	16	420977479	5	529026500	32	529035547	8
408201100	2	420977480	5	529026600	32	529035549	8
408803500	2	420977490	5	529026700	25	529035550	19
414012200	19	420977494	5	529027300	25	529035557	27
414104700	2	484300139	19	529027600	25	529035559	8
414348200	24	503190102	32	529028700	32	529035561	8
414837300	35	517234900	5	529028800	25	529035562	8
420267930	2	520000126	32	529029100	7	529035563	8
420276025	2	529000012	32	529030000	26	529035565	8
420277010	19	529002100	24	529030100	26	529035567	8
420277875	2	529002800	24	529030200	26	529035569	8
420277905	18	529005000	32	529030300	26	529035570	33
420476010	24	529005500	24	529030500	7	529035572	27
420476020	24	529006400	24	529030600	36	529035575	27
420840681	2	529006500	24	529030800	7	529035576	27
420841201	2	529007200	24	529030900	26	529035582	33
420876081	2	529007700	24	529031100	26	529035584	27
420876171	2	529007900	24	529031200	26	529035586	27
420876330	3	529008700	24	529031300	26	529035588	27
420876357	18	529010100	25	529031400	26	529035591	16
420876490	3	529010600	25	529031800	36	529035594	28
420876500	3	529010700	25	529031900	19	529035603	16
420876501	3	529010800	25	529032100	16	529035607	8
420876510	3	529010902	5	529032300	26	529035608	33
420876512	18	529011000	5	529032500	36	529035652	22
420876514	3	529011200	5	529032900	32	529035661	8
420876516	3	529011203	6	529033100	7	529035674	28
420876552	3	529012900	36	529033300	19	529035675	19
420876557	3	529014500	19	529033800	19	529035676	19
420876569	3	529015200	25	529034100	33	529035679	20
420876605	3	529016900	6	529034200	26	529035681	20
420876607	18	529017100	32	529034400	35	529035686	9
420876610	3	529017200	25	529034600	19	529035687	9
420876612	4	529020000	36	529035300	26	529035697	20
420876620	4	529020800	6	529035400	7	529035699	28
420876660	4	529021100	6	529035501	27	529035709	16
420876695	4	529021200	6	529035503	7	529035714	16
420876822	4	529021300	6	529035504	33	529035724	9
420876824	4	529021302	6	529035513	7	529035727	33
420876904	4	529021400	18	529035520	16	529035728	33

Index

Tool Part Numbers ... Page

These tools are mandatory

529035730 20	529035919 10	529036006 18	529036143 22
529035748 20	529035921 10	529036007 34	529036145 30
529035764 9	529035926 10	529036009 29	529036146 30
529035765 9	529035930 34	529036010 29	529036147 30
529035766 9	529035931 28	529036011 13	529036148 14
529035769 33	529035936 31	529036012 29	529036149 14
529035808 28	529035939 28	529036014 13	529036150 31
529035812 28	529035940 10	529036016 21	529036151 14
529035815 28	529035942 29	529036018 21	529036152 30
529035821 9	529035943 21	529036019 21	529036153 14
529035822 9	529035944 10	529036022 13	529036154 14
529035823 18	529035945 34	529036023 17	529036155 14
529035826 28	529035952 10	529036028 13	529036156 14
529035827 33	529035953 10	529036029 13	529036157 15
529035828 20	529035957 29	529036031 13	529036158 23
529035829 9	529035958 11	529036032 13	529036159 15
529035830 9	529035959 29	529036033 13	529036160 15
529035831 28	529035960 11	529036034 13	529036161 15
529035832 28	529035961 11	529036035 29	529036163 17
529035835 16	529035962 11	529036037 17	529036164 30
529035836 16	529035963 11	529036038 22	529036165 30
529035837 16	529035964 11	529036042 22	590122400 17
529035838 16	529035965 11	529036043 23	71000851 22
529035839 9	529035966 11	529036044 29	860414200 31
529035868 20	529035967 11	529036045 23	861205900 23
529035869 20	529035968 11	529036057 23	861725700 31
529035873 33	529035969 11	529036060 13	861725800 15
529035874 33	529035970 11	529036061 14	861743900 34
529035875 33	529035971 12	529036062 21	861749100 15
529035876 34	529035972 12	529036063 21	861780600 22
529035878 20	529035973 12	529036064 29	AMP 755430-2 22
529035880 9	529035974 29	529036065 29	Snap-on CJ125-6 36
529035891 16	529035975 34	529036066 29	Snap-on RC 980 15
529035894 28	529035976 12	529036067 30	Snap-on TA362 15
529035896 20	529035979 12	529036108 23	Snap-on TT600-4 22
529035897 31	529035980 12	529036110 30	Snap-on YA 8230 15
529035899 17	529035981 21	529036111 30	
529035900 10	529035983 36	529036112 30	
529035901 34	529035989 36	529036117 36	
529035902 34	529035990 12	529036118 17	
529035903 34	529035991 18	529036121 34	
529035904 20	529035993 21	529036122 30	
529035906 20	529035997 21	529036127 30	
529035907 34	529035998 12	529036129 21	
529035908 21	529035999 12	529036130 14	
529035909 21	529036000 12	529036131 14	
529035910 10	529036001 12	529036132 14	
529035911 10	529036002 12	529036136 17	
529035913 10	529036003 13	529036137 17	
529035914 10	529036004 13	529036138 14	